

Installation Instructions

for use by heating contractor



Insulated Braided Connection Pipe

Part No. 7831630

For use with: Vitodens 222-F, B2TA/B2TB

Safety and Installation Requirements

Please ensure that these instructions are read and understood before starting any service work. Failure to comply with these instructions may cause product/property damage, severe personal injury and/or loss of life.

Working on the equipment

The installation, adjustment, service and maintenance of this product must be performed by a licensed professional heating contractor who is qualified and experienced in the installation, service, and maintenance of hot water boilers. There are no user serviceable parts on the boiler, burner or control.

Ensure that main power to the equipment being serviced is off.

Ensure that the main fuel supply valve to the boiler is closed.

Take precautions to avoid accidental activation of power or fuel during service work.

Do not perform service work on any component part without ensuring safe operation of the heating system. When replacing parts, use original Viessmann or Viessmann approved replacement parts.



Refer to the Installation and Service Instructions applicable to this boiler.

Accessing the Connecting Pipe

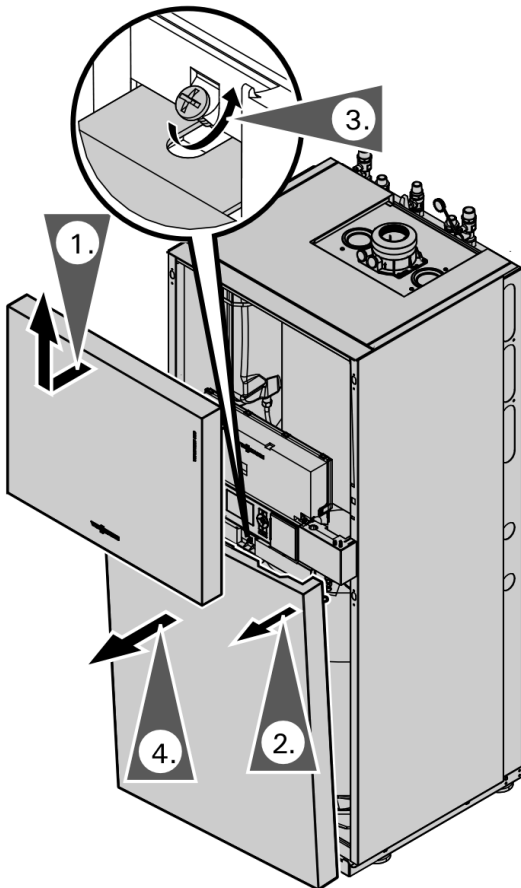

1. Remove the front upper panel.
2. Tilt the lower front panel.
3. Remove the retaining screw and set aside.
4. Remove the lower front panel.
5. Pivot control unit forward.

Connecting Pipe Replacement

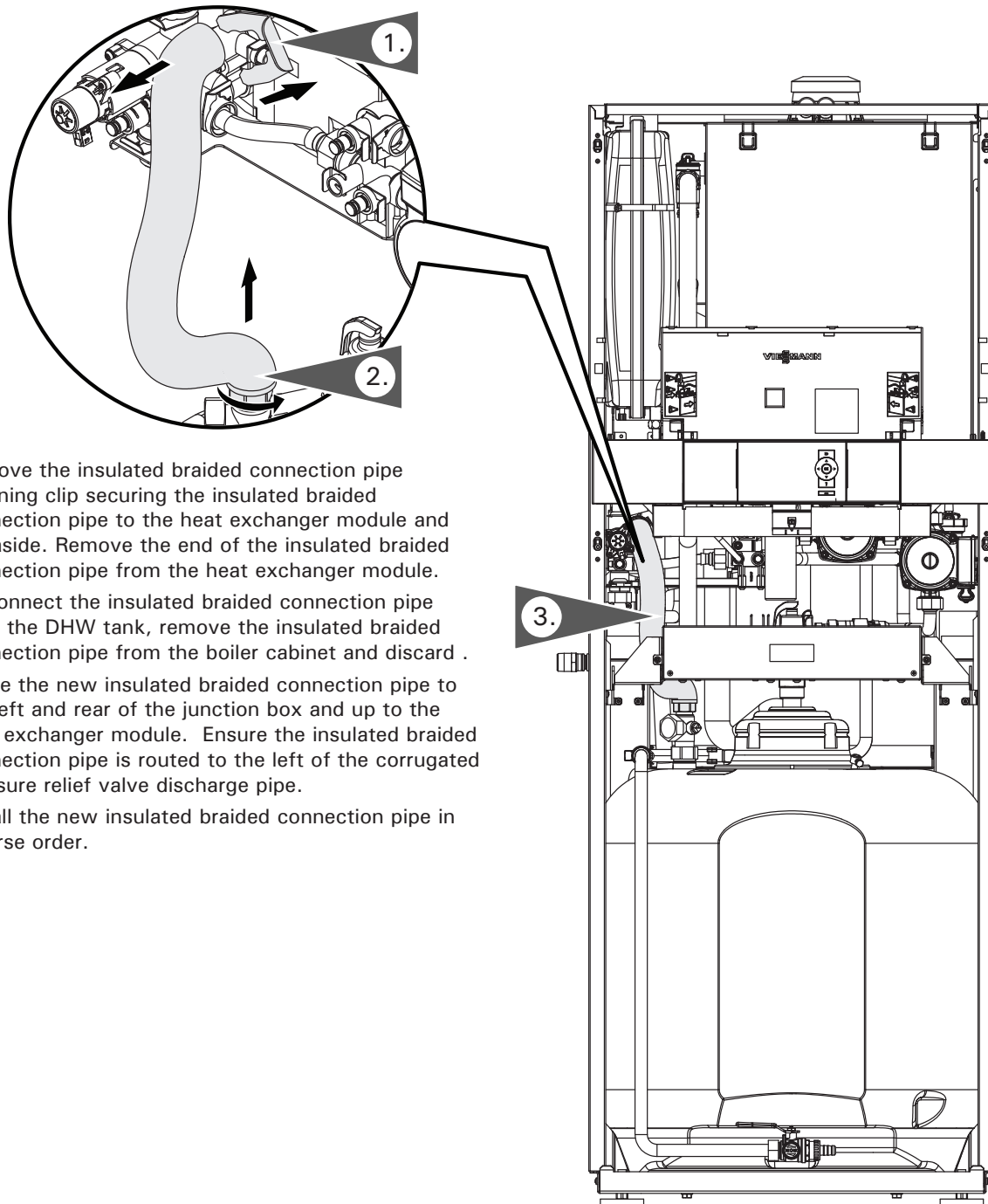

1. Remove the insulated braided connection pipe retaining clip securing the insulated braided connection pipe to the heat exchanger module and set aside. Remove the end of the insulated braided connection pipe from the heat exchanger module.
2. Disconnect the insulated braided connection pipe from the DHW tank, remove the insulated braided connection pipe from the boiler cabinet and discard .
3. Route the new insulated braided connection pipe to the left and rear of the junction box and up to the heat exchanger module. Ensure the insulated braided connection pipe is routed to the left of the corrugated pressure relief valve discharge pipe.
4. Install the new insulated braided connection pipe in reverse order.