

# Installation and service instructions

**VIESSMANN**

Switch mounting thermostat with touchpad

## **VITOPLANAR** Switch mounting thermostat



## Safety instructions

Please follow these safety instructions closely to prevent hazards, injury and material losses.

### Safety instructions explained

#### **.. Danger**

This symbol warns against the risk of injury.

**! Caution**  
This symbol warns against the risk of material losses and environmental pollution.

#### **Note**

*Text with the word Note contains additional information.*

Installation, commissioning, inspection, maintenance and repairs must only be carried out by an authorised, competent person (heating engineer/installation contractor).

Before working on the appliance/heating system, isolate it from the power supply (e.g. by removing a separate fuse or by means of a mains isolator) and safeguard against unauthorised reconnection.

Repairing components that fulfil a safety function can compromise the safe operation of the system.

For replacements, use only original spare parts supplied or approved by Viessmann.

## **Product information**

The thermostat is an underfloor heating thermostat equipped with a 1.8 inch TFT colour screen and capacitive contact surfaces for easy and clear navigation.

The thermostat features a variety of energy saving programs with individually adjustable times and temperatures. The adaptive function means that the thermostat collects data from the start and uses it to calculate the switch-on time.

A PI controller keeps temperature fluctuations to a minimum, ensuring uniform heating.

The thermostat also has a ventilation function that turns the heating off for 15 minutes if the temperature drops by more than 3 °C per minute.

## Standard delivery

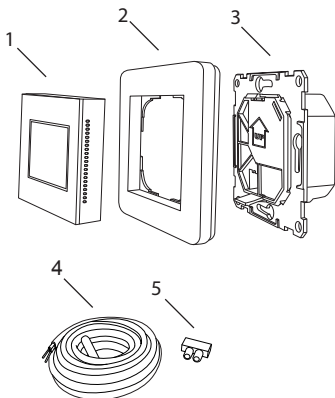

- 1 Front section
  - 2 Frame
  - 3 Thermostat
  - 4 Floor sensor
  - 5 Terminal
- Documentation

## Installation location

The thermostat should not be exposed to direct sunlight or draughts, otherwise its function may be impaired. Note the IP rating of the thermostat during installation.

## Installation sequence

### Installing the floor sensor



Installation instructions for the heating mat

### Installing the thermostat

The thermostat is mounted in a 65 mm surface box. The box should be flush with the wall or tiles.

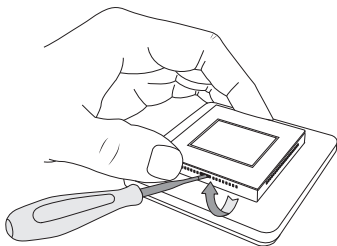

1. Press the screwdriver into the groove on the underside and lift the front section upwards until you hear a "click".
2. Lift off the front section and frame.

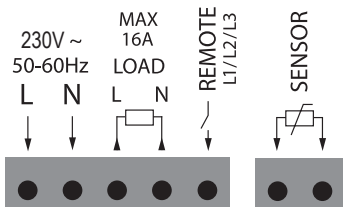

3. Make the connection according to the instructions on the back of the thermostat. The protective conductor for the power supply and

the heating cable is connected to a terminal on the box.



Installation instructions for the heating mat

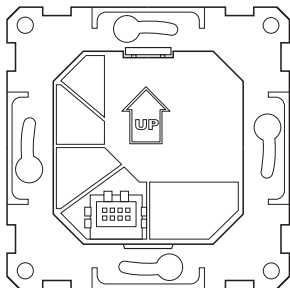

4. Insert the thermostat into the surface box with the arrow pointing upwards and secure with the screws provided.

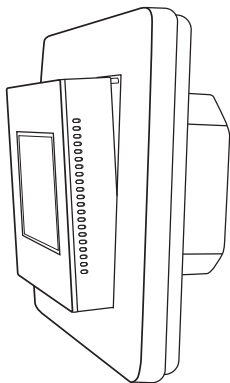

5. Place on the frame. First hook the front section in at the bottom and then press it in at the top until it audibly engages.



## Commissioning



For operating and display elements, see the "Vitoplanar switch mounting thermostat" operating instructions

The thermostat has an integral start assistant that guides you through each step. When the thermostat is supplied with power for the first time, the system guides you through the standard and important settings that need to be made.

After the screed has been applied, wait four weeks before starting up the underfloor heating system. The screed must dry out thoroughly. The thermostat automatically performs a countdown and starts up the underfloor heating system after 4 weeks.

## Service functions

Call up the "Installer" menu point.

## System info

Displays settings and calibrations

## Applications

Hotel	Active	Default setting: 25 °C Setting range: 20 to 27 °C
	Standby	Default setting: 15 °C Setting range: (Off) 5 to 20 °C
	Reheating	Default setting: 2 h Setting range: 0 to 4 h
	Area	Min. Default setting: 22 °C Setting range: 20 to 23 °C
		Max. Default setting: 27 °C Setting range: 25 to 30 °C
Remote control	On/Off	If the remote control is switched on, a remote control is visible in the "Program" menu. Requires a 230 V signal at the remote input.

Comfort heating (low power heating)	On/Off	Default setting: 25/20 °C Setting range: 5 to 27 °C See "Home" program for times and other temperatures
Output control		Shown in % Pause/runtime 20 min (in cycles). The current temperature is shown on the display

## Sensors

### Note

*In rooms with strong sunlight (large windows), we recommend the room and floor thermostat function.*

*In rooms with wooden floors, the room and floor thermostat function should always be used.*

Sensor selection	Floor sensor	Tiles/stone
	Room sensor	Tiles/stone
	Room sensor + lim. floor sensor	Wood/laminate/plastic Max. (overheating) Default setting: 30 °C Setting range: 27 to 35 °C Min. (comfort) Default setting: 5 °C Setting range: (Off) 5 to 25 °C
	Floor sensor + lim. room sensor	Tiles/stone/wood/laminate/plastic/vinyl Max. (room limit) Default setting: 25 °C Setting range: 20 to 27 °C
Sensor type	NTC 2 kΩ NTC 10 kΩ NTC 12 kΩ NTC 15 kΩ NTC 22 kΩ NTC 33 kΩ NTC 47 kΩ NTC 100 kΩ	For support, the current temperature for the relevant sensor type is displayed.
Calibration	Floor sensor Room sensor	The relevant sensor can be calibrated if necessary.

## Installed output

Setting required to display energy consumption.  
Default setting: 400 W

## Functions

Adaptive function	On/Off (adjustable On)
Ventilation function	On/Off (adjustable On)
Delayed start	Start heating in four weeks? OK/No
Runtime limit	The underfloor heating system is switched off for x minutes per hour. Default setting: Off Setting range: 1 to 15 min

## Reset

Reset all	All settings are reset.
Save data	Energy consumption is saved. Other settings are reset.

## Operating information

The thermostat display shows operating information below the set value.

Call up the "Operating information" menu point.

Now	Display of the current temperature and current sensor	
In X:XX (time in hours until the set value is reached)	Set	Set value reached
	Limit	Max. limit or min. limit is active. The function is activated when the sensor is selected
	Ventilation	The ventilation function switches the heating off for a period of 15 minutes as soon as the temperature drops by more than 3 °C per minute.

## Troubleshooting

If a fault occurs, the thermostat switches the heating off. A fault code is shown on the display.

### Fault codes

- E1 Short circuit, room sensor
- E2 Lead break, room sensor
- E3 Short circuit, floor sensor
- E4 Lead break, floor sensor
- E5 Internal sensor fault
- E6 Internal excess temperature

## Floor sensor resistance values

For a control measurement of the floor sensor, the following values apply for standard sensors NTC 10 k $\Omega$ .

Temperature	Resistance
10 °C	18.0 k $\Omega$
15 °C	14.7 k $\Omega$
20 °C	12.1 k $\Omega$
25 °C	10.0 k $\Omega$ (standard)
30 °C	8.3 k $\Omega$

## Changing the front cover

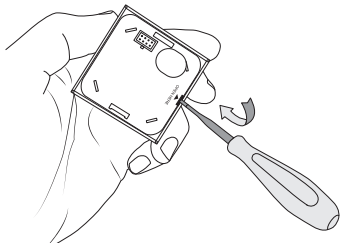

1. Press the screwdriver into the groove on the underside and lift the front section upwards until you hear a "click".

- 
2. Lift off the front section and frame.

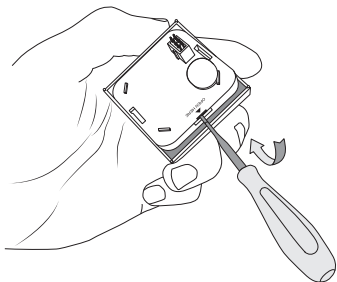

3. Use a screwdriver to carefully remove the front cover from the back panel.

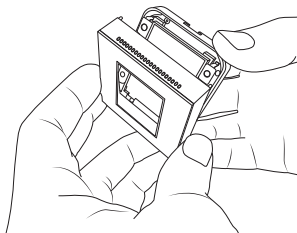

4. Put the new front cover in place and press until it audibly engages.



## Disposal of packaging

Your contractor will dispose of the packaging from your Viessmann product.

**DE:** Packaging waste is sent to a certified disposal contractor for recycling in line with statutory regulations.

**AT:** Packaging waste is sent to a certified disposal contractor for recycling in line with statutory regulations. Use the ARA statutory disposal system (Altstoff Recycling Austria AG, licence number 5766).

## Specification

Power supply	230 VAC $\pm 10\%$ , 50 to 60 Hz
Air temperature range	+5 to +35 °C
Floor temperature range	+5 to +35 °C
Temperature limiter	+5 to +35 °C
Breaking capacity	3680 W/16 A/230 VAC
Connecting cable	Max. 2.5 mm <sup>2</sup>
Resistance	$\cos \varphi = 1$
Switching differential	$\pm 0.3$ °C
Operating reserve	36 h
Sensor lead	3 m, NTC 10 k $\Omega$
Max. sensor lead extension	50 m; 2 x 1.5 mm <sup>2</sup>
Dimensions of display	36 x 29 mm
Dimensions of thermostat	87 x 87 x 39 mm
For frame system	Schneider Exxact, ELKO Plus/RS
Colour	White
IP rating	IP 21
Certification	CE, S

## Energy consumption data

The product data corresponds to the EU regulations of the directive on the environmentally sound design of energy related products (ErP).

## Declaration of Conformity

Using the serial number, the Declaration of Conformity can be found on the following website:

DE: **[www.viessmann.de/eu-conformity](http://www.viessmann.de/eu-conformity)**

AT: **[www.viessmann.at/eu-conformity](http://www.viessmann.at/eu-conformity)**

CH: **[www.viessmann.ch/eu-conformity-de](http://www.viessmann.ch/eu-conformity-de)**

or

**[www.viessmann.ch/eu-conformity-fr](http://www.viessmann.ch/eu-conformity-fr)**

Viessmann Ges.m.b.H.  
A-4641 Steinhaus bei Wels  
Telephone: 07242 62381-110  
Fax: 07242 62381-440  
[www.viessmann.at](http://www.viessmann.at)

Viessmann Werke GmbH & Co. KG  
D-35107 Allendorf  
Telephone: +49 (0)6452 70-0  
Fax: +49 (0)6452 70-2780  
[www.viessmann.de](http://www.viessmann.de)