

## Replacing the circulation pump

---

### Safety instructions



Please follow these safety instructions closely to prevent accidents and material losses.

---

### Safety instructions explained

#### Note

Details identified by the word "Note" contain additional information.

Installation, commissioning, inspection, maintenance and repairs must only be carried out by an authorised, competent person (heating engineer/installation contractor).

Before working on the appliance/heating system, isolate it from the power supply (e.g. by removing a separate mains fuse or by means of a mains isolator) and safeguard against unauthorised reconnection.

When using gas as fuel, also close the main gas shut-off valve and safeguard against unintentional reopening.

Check for gas tightness after installation.

Wear suitable personal protective equipment when carrying out any work.

Repairing components that fulfil a safety function can compromise the safe operation of the system.

For replacements, use only original spare parts supplied or approved by Viessmann.

Install the components with new gaskets.

### High efficiency circulation pumps from well known manufacturers

All high efficiency circulation pumps in the product range comply with the EU Declaration of Conformity.

- Low Voltage Directive
- EMC Directive
- ErP Directive

They are therefore generally backwards compatible.

## High efficiency circulation pumps from well... (cont.)

The manufacturer's instructions, in particular regarding sizing and the electrical connection, must be observed.

## Removing the pump

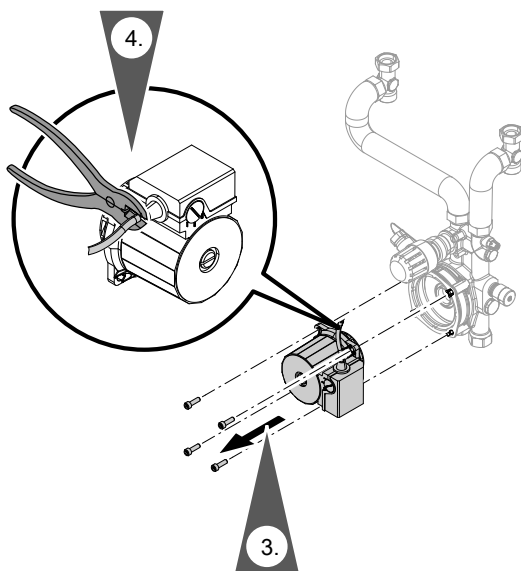
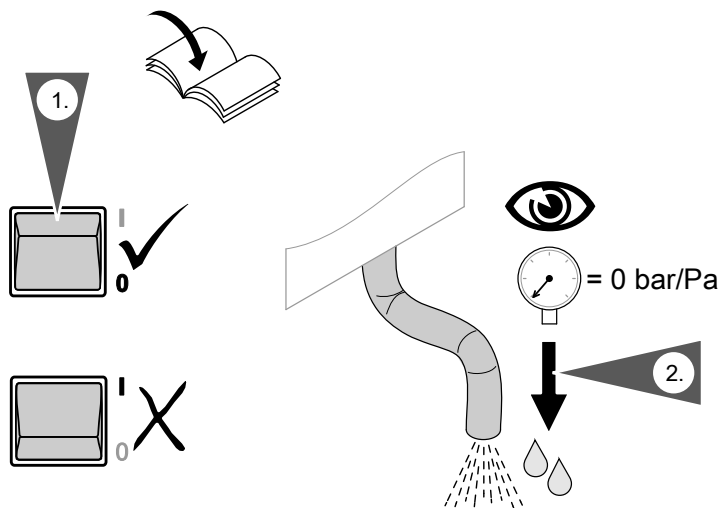

## Installing the new high efficiency pump

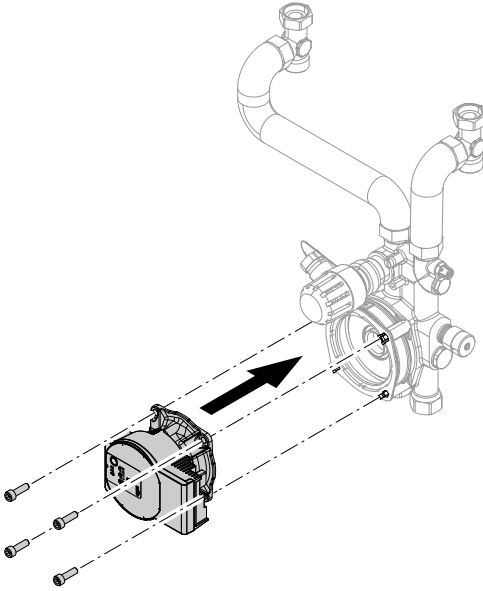

## Electrical connection of the high efficiency pump plug

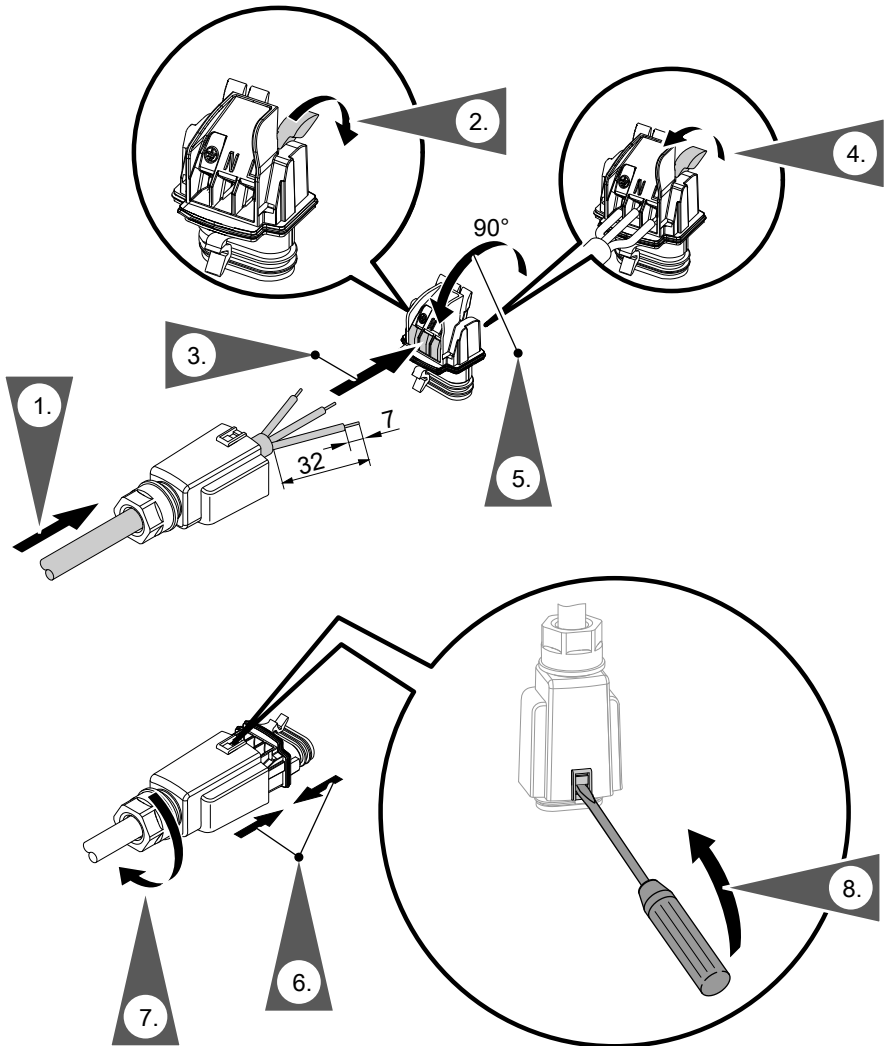

## Electrical connection of the high efficiency... (cont.)

### Inserting the plug and plug adaptor

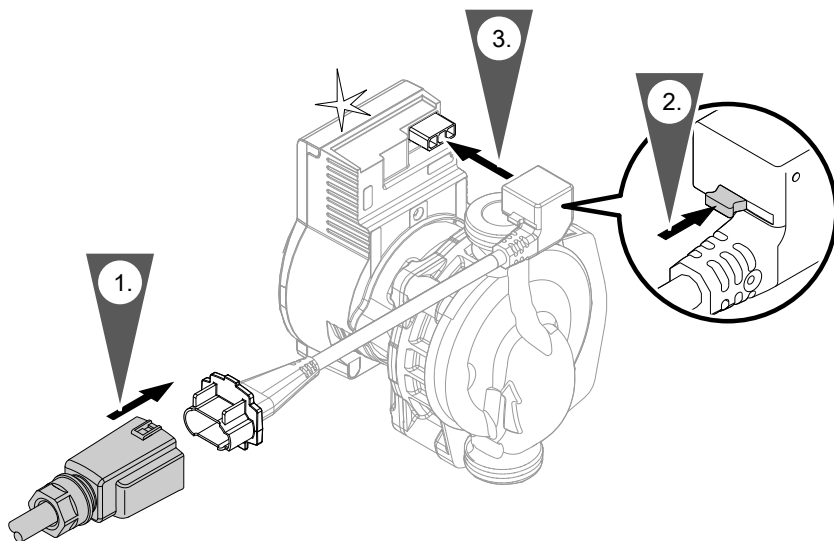

# Commissioning

## Filling the system

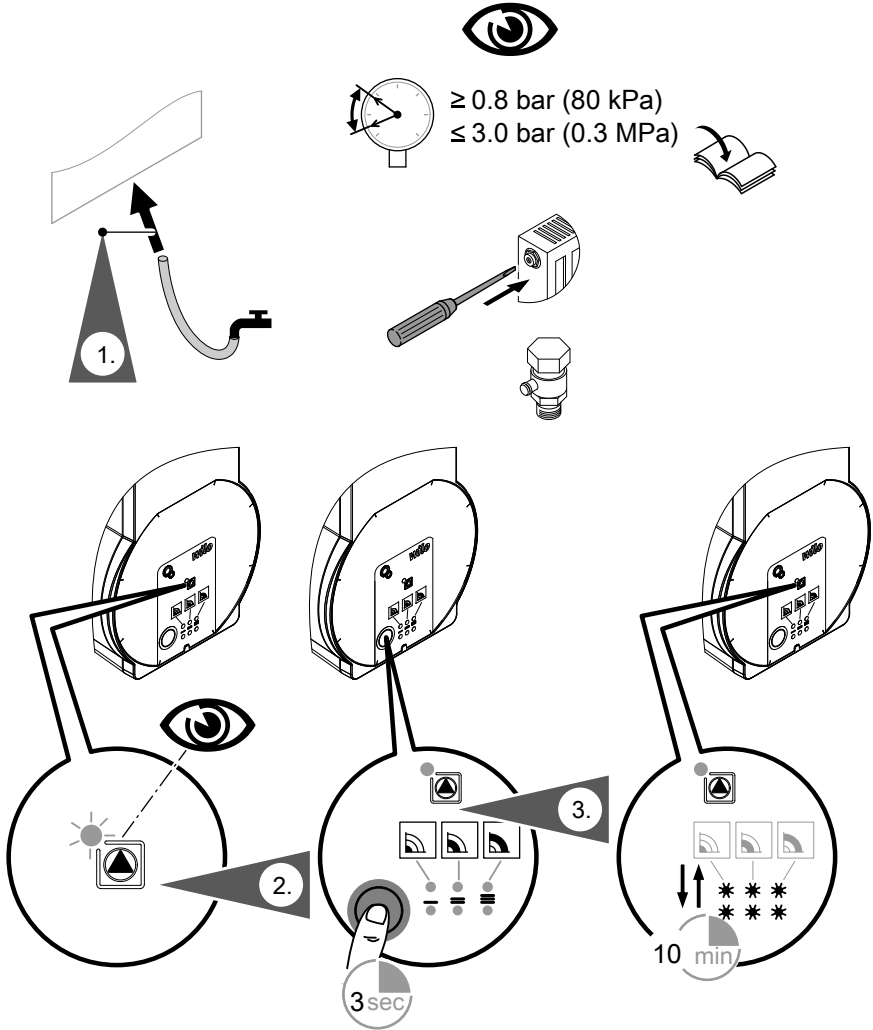

## Commissioning (cont.)

Set up the new pump as detailed in the table on page 10:

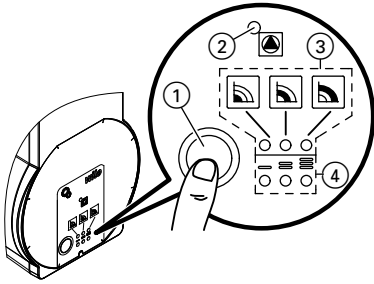

- ① Operating button for setting the pump
- ② Operating/fault indicator LED
- ③ Display of the selected speed control range
- ④ Display of the selected curve (I, II, III)

### Setting the control mode

The LEDs showing the selected control modes and corresponding curves move in a clockwise direction.

- Press the operating button briefly (for approx. 1 second) to move through the various control settings.  
→ The LEDs show the control mode and curve for each setting.

### Constant speed (I, II, III)

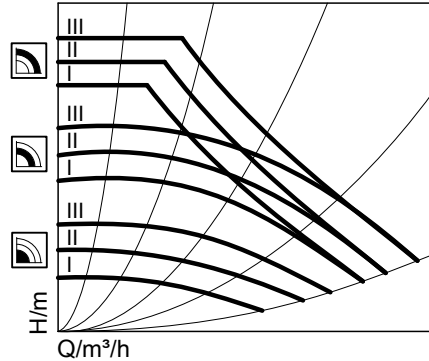









The table below shows all the possible settings (e.g. speed control range "high"; setting/curve III).

#### Note

*After the button is pressed for the ninth time, you return to the standard setting.*

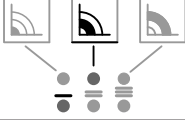

## Commissioning (cont.)

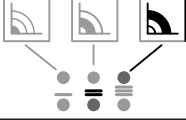
Press the operating button (for 1 second each time)	LED indicator	Control type	Setting/ Curve
Press 1 time		Speed control range: High	I
Press 2 times		Speed control range: Low	III
Press 3 times		Speed control range: Low	II
Press 4 times		Speed control range: Low	I
Press 5 times		Speed control range: Medium	III
Press 6 times		Speed control range: Medium	II
Press 7 times		Speed control range: Medium	I
Press 8 times		Speed control range: High	III
Press 9 times		Speed control range: High	II

## Commissioning (cont.)

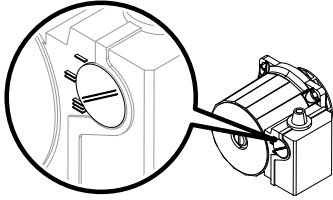

### Existing setting on old pump

### Recommended setting on new high efficiency pump

4 m pump: MIN (I) setting		Speed control range: Low	I
4 m pump: Medium (II) setting		Speed control range: Low	II
4 m pump: MAX (III) or variable (KM-BUS) setting		Speed control range: Low	III
5 m pump: MIN (I) setting		Speed control range: Medium	I
5 m pump: Medium (II) setting		Speed control range: Medium	II
5 m pump: MAX (III) or variable (KM-BUS) setting		Speed control range: Medium	III
6 m pump: MIN (I) setting		Speed control range: Medium	III

## Commissioning (cont.)

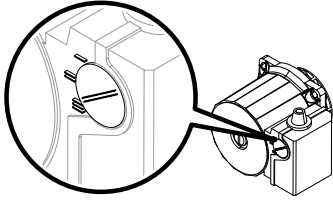

### Existing setting on old pump

### Recommended setting on new high efficiency pump

6 m pump: Medium (II) setting		Speed control range: High	I
6 m pump: MAX (III) or variable (KM-BUS) setting		Speed control range: High	II
7 m pump: MIN (I) setting		Speed control range: High	I
7 m pump: Medium (II) setting		Speed control range: High	II
7 m pump: MAX (III) or variable (KM-BUS) setting		Speed control range: High	III

## Commissioning (cont.)

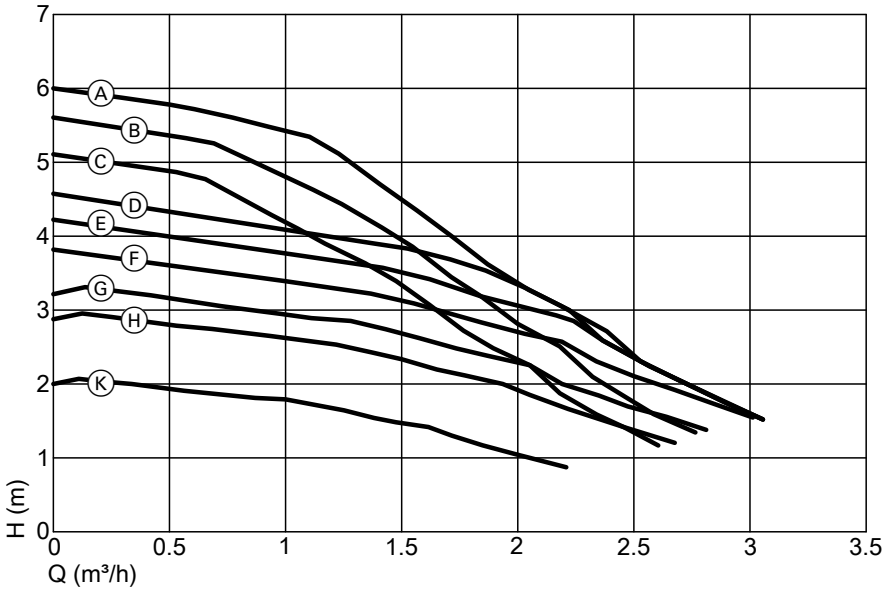

- |                |              |
|----------------|--------------|
| Ⓐ High (III)   | Ⓕ Medium (I) |
| Ⓑ High (II)    | Ⓖ Low (III)  |
| Ⓒ High (I)     | Ⓗ Low (II)   |
| Ⓓ Medium (III) | Ⓚ Low (I)    |
| Ⓔ Medium (II)  |              |

### Only when replacing KM-BUS pumps

#### Note

Change the parameter/code from "internal pump speed-controlled" to "internal pump **NOT** speed-controlled"!

Otherwise the pump will run continuously and a fault message will be displayed.

## Commissioning (cont.)

### Constant temperature control unit with programming unit (BT2)

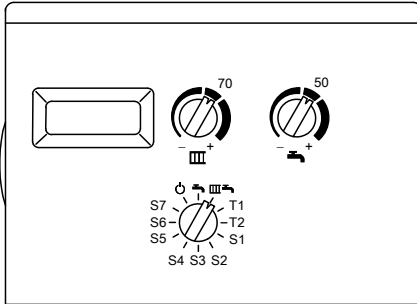

1. Select service setting "S3" on the operating program selector switch.
2. Turn rotary selector "III" fully anti-clockwise. "Eb. 1" flashes on the display.
3. Turn rotary selector "III" fully clockwise. "Eb. 2" flashes and then jumps to the value of the service setting.
4. Use rotary selector "-" to set the value to "0" if a different value is set.
5. Set the operating program selector switch to a different position. The value is now saved.

### Weather-compensated control unit with standard programming unit (BES)

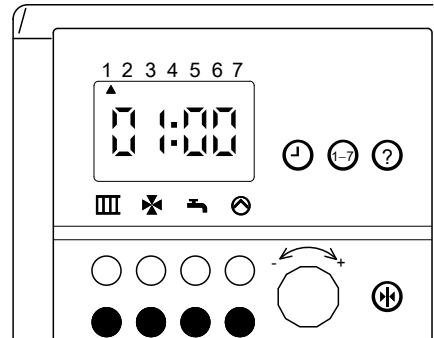

1. Press red button "-" and blue button "X" at the same time. Keep the buttons pressed for about 5 seconds until "01:00" appears
2. Press button "⊖" and turn rotary switch "-↔+" clockwise until coding address "12:.." appears.
3. Press button "1-7". Turn rotary selector "-↔+" and set value "12:00" if a different value is set.
4. Press button "III" to exit the coding level.

## Commissioning (cont.)

### Weather-compensated control unit with Comfortrol programming unit (BEM)

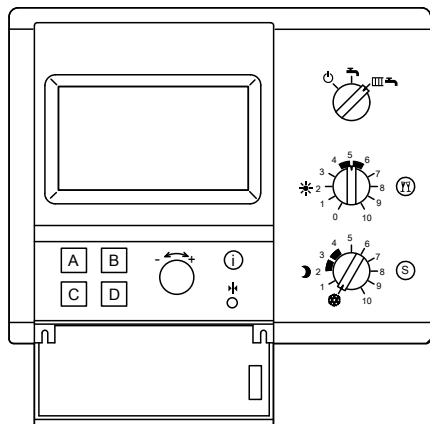

1. Open the flap:  
System: Press **"D"**.  
Contractor setting: Press **"C"**.  
Enter code: Press **"B-C-C-B"**.  
Coding level 2: Press **"C"**.
2. Press **"A"** (next) or **"B"** (back) to select coding address "013: ...".
3. Use selector "**-↔+**" to set coding address "013:000" if a different value is set.
4. Press **"D"** to confirm the change.  
The change is saved.

### Constant temperature control unit

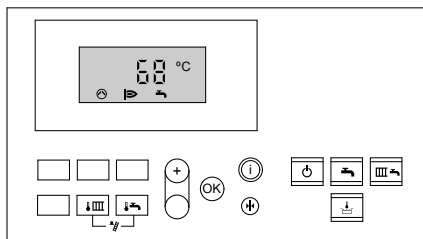

### Calling up coding level 2







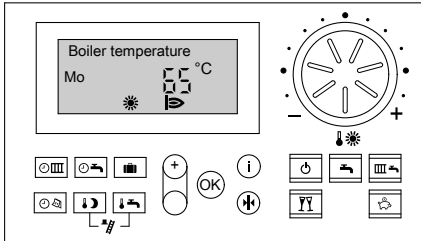



1. Press and simultaneously for approx. 2 s; confirm with .
2. Use or to select coding address "30: . "; the address flashes. Confirm with ; the value flashes.
3. Use or to set "30:0" if a different value is set; confirm with . The display briefly shows "Accepted", then the address flashes again.
4. Press and simultaneously for approx. 1 s.  
Coding level is exited.

## Commissioning (cont.)

### Weather-compensated control unit

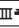

### Calling up coding level 2

1. Press  and  simultaneously for approx. 2 s; confirm with .
2. Use  or  to select coding address "30: ."; the address flashes. Confirm with ; the value flashes.
3. Use  or  to set "30:0" if a different value is set; confirm with . The display briefly shows "Accepted", then the address flashes again.
4. Press  and  simultaneously for approx. 1 s. Coding level is exited.



Viessmann Climate Solutions SE  
35108 Allendorf / Germany  
Telephone: +49 6452 70-0  
Fax: +49 6452 70-2780  
[www.viessmann.com](http://www.viessmann.com)



Viessmann Limited  
Hortonwood 30, Telford  
Shropshire, TF1 7YP, GB  
Telephone: +44 1952 675000  
Fax: +44 1952 675040  
E-mail: [info-uk@viessmann.com](mailto:info-uk@viessmann.com)

6179297 Subject to technical modifications.