

## DHW expansion vessel

for Vitodens 111-W/222-W

---

### Safety instructions



**Please follow these safety instructions closely to prevent accidents and material losses.**

---

### Safety instructions explained



#### **Please note**

This symbol warns against the risk of material losses and environmental pollution.

#### **Note**

*Details identified by the word "Note" contain additional information.*

---

Installation, commissioning, inspection, maintenance and repairs must only be carried out by an authorised, competent person (heating engineer/installation contractor).

Before working on the appliance/heating system, isolate it from the power supply (e.g. by removing a separate mains fuse or by means of a mains isolator) and safeguard against unauthorised reconnection.

When using gas as fuel, also close the main gas shut-off valve and safeguard against unintentional reopening.

Check for gas tightness after installation.

Wear suitable personal protective equipment when carrying out any work.

Repairing components that fulfil a safety function can compromise the safe operation of the system.

For replacements, use only original spare parts supplied or approved by Viessmann.

Install the components with new gaskets.

## Draining the boiler on the DHW side



### Please note

Risk of scalding

Do not drain the boiler or heating system until the boiler water and cylinder temperature have dropped below 40 °C.

Turn off the ON/OFF switch on the control unit.

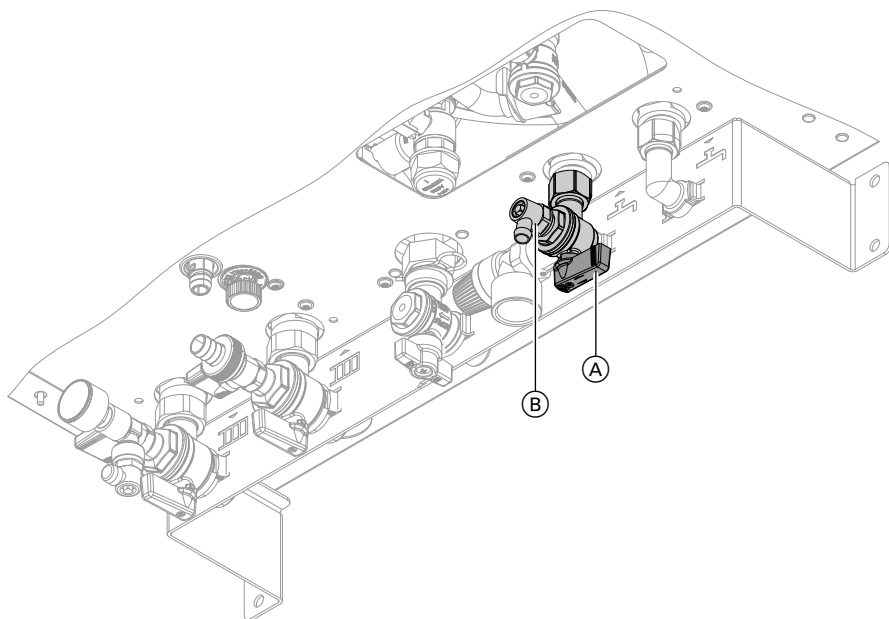

1. Close cold water shut-off valve (A).  
Open hot water draw-off point.
2. Connect hose to drain valve (B)  
and route it into a suitable container  
or drain outlet.

### Note

Ensure adequate ventilation in the  
DHW pipework.

## Opening the boiler

### Removing the front panel

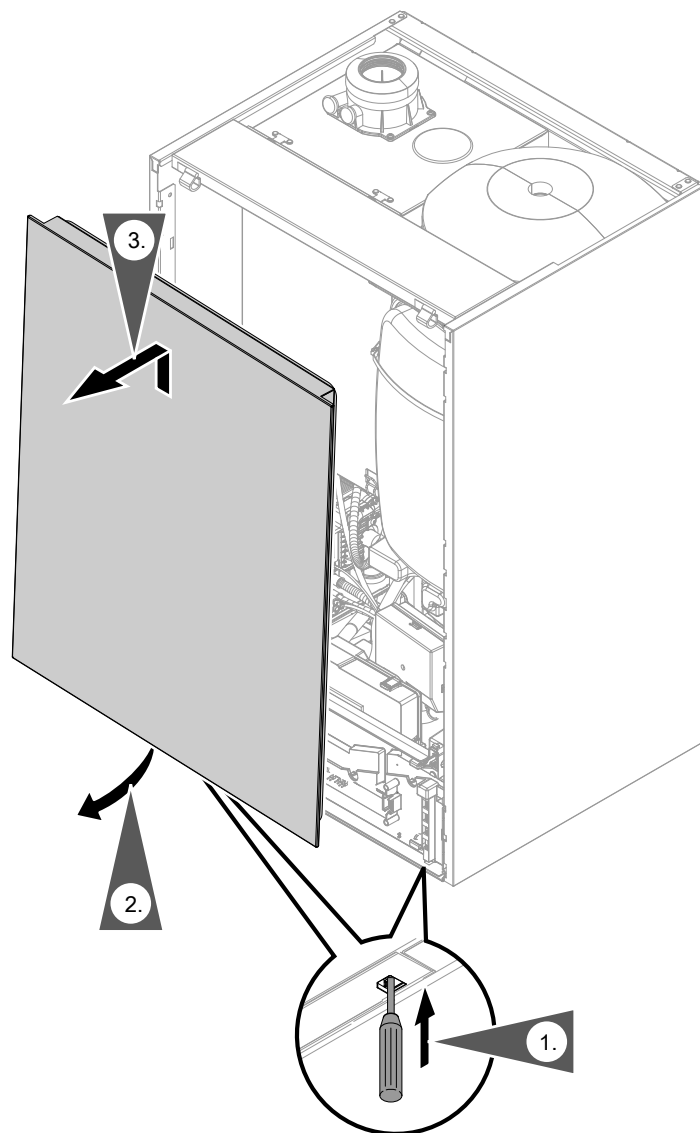

## Opening the boiler (cont.)

### Pivoting down the control unit enclosure

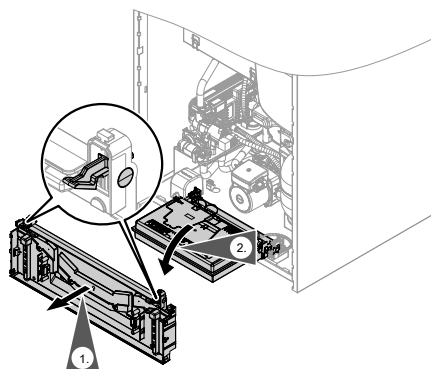

Vitodens 111-W

1. Unlock the mounting bracket for the programming unit and move it into the maintenance position.

 Installation and service instructions

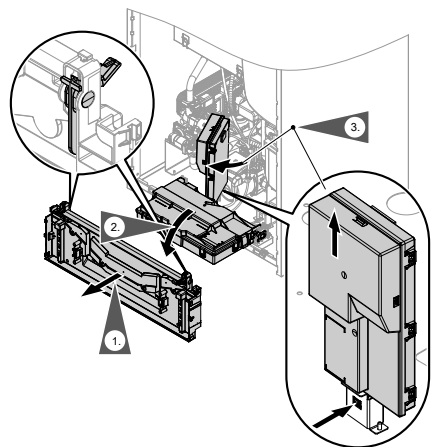

Vitodens 222-W

## Fitting the DHW expansion vessel

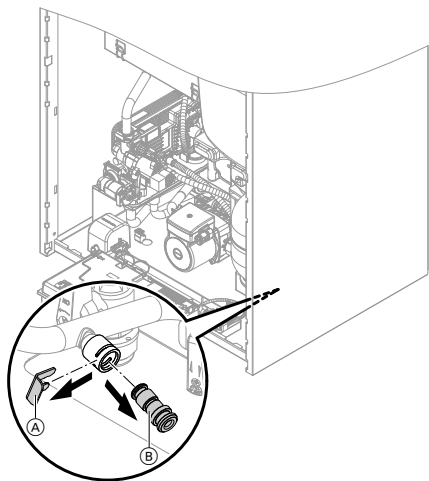

Vitodens 111-W

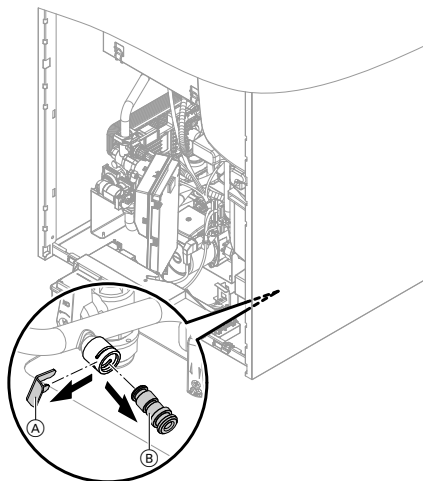

Vitodens 222-W

1. Remove clip (A) from the cold water connection distributor. Remove plug (B).



### Please note

Residual water may escape when the plug is removed.



## Fitting the DHW expansion vessel (cont.)

2. Attach connection line (B) for the DHW expansion vessel. Insert clip (A).

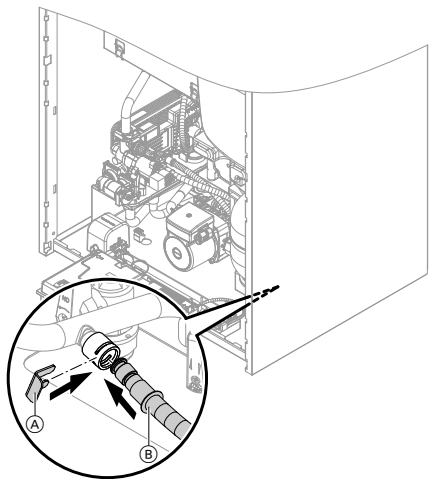

Vitodens 111-W

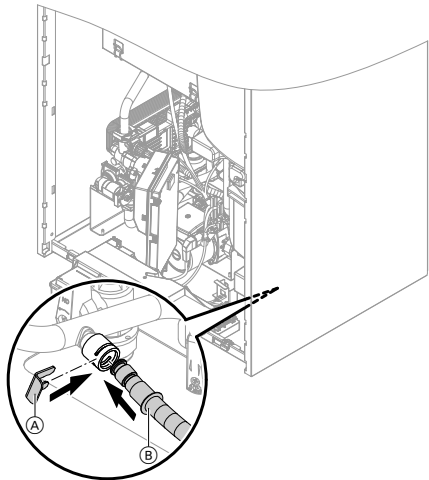

Vitodens 222-W

## Fitting the DHW expansion vessel (cont.)

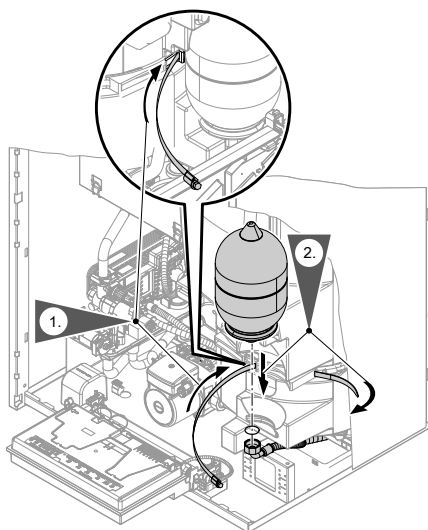

Vitodens 111-W

1. Attach the hose clip to the lower bracket of the DHW cylinder.

### **Note**

*Route the connection line for the DHW expansion vessel in front of the electrical cables so that they are not pressed against sharp edges.*

2. Secure the DHW expansion vessel with the hose clip. Connect the connection line with a gasket.

3. Fill the DHW cylinder.

### **Note**

*Carry out a leak test.*

*Check the static pressure of the DHW line downstream of the pressure reducer and adjust if required.*

*Set value: Max. 3.0 bar (0.3 MPa)*

*Check the pre-charge pressure of the DHW expansion vessel and adjust if required. Set value: Static pressure minus 0.2 bar (20 kPa)*



Installation and service instructions

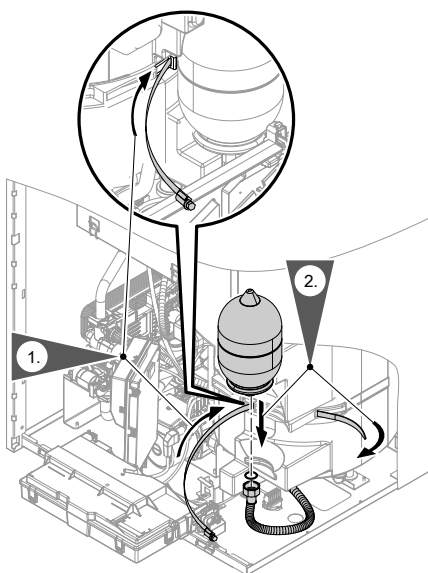

Vitodens 222-W

4. Assemble in reverse order.

Viessmann Climate Solutions SE  
35108 Allendorf  
Telephone: +49 6452 70-0  
Fax: +49 6452 70-2780  
[www.viessmann.com](http://www.viessmann.com)



Viessmann Limited  
Hortonwood 30, Telford  
Shropshire, TF1 7YP, GB  
Telephone: +44 1952 675000  
Fax: +44 1952 675040  
E-mail: [info-uk@viessmann.com](mailto:info-uk@viessmann.com)

5853836 Subject to technical modifications.