

Replacing the circulation pump

Safety instructions



Please follow these safety instructions closely to prevent accidents and material losses.

Safety instructions explained

Note

Details identified by the word "Note" contain additional information.

Installation, commissioning, inspection, maintenance and repairs must only be carried out by an authorised, competent person (heating engineer/installation contractor).

Before working on the appliance/heating system, isolate it from the power supply (e.g. by removing a separate mains fuse or by means of a mains isolator) and safeguard against unauthorised reconnection.

When using gas as fuel, also close the main gas shut-off valve and safeguard against unintentional reopening.

Check for gas tightness after installation.

Wear suitable personal protective equipment when carrying out any work.

Repairing components that fulfil a safety function can compromise the safe operation of the system. For replacements, use only original spare parts supplied or approved by Viessmann.

Install the components with new gaskets.

High efficiency circulation pumps from well known manufacturers

All high efficiency circulation pumps in the product range comply with the EU Declaration of Conformity.

- Low Voltage Directive
- EMC Directive
- ErP Directive

They are therefore generally backwards compatible.

High efficiency circulation pumps from well... (cont.)

The manufacturer's instructions, in particular regarding sizing and the electrical connection, must be observed.

Removing the pump

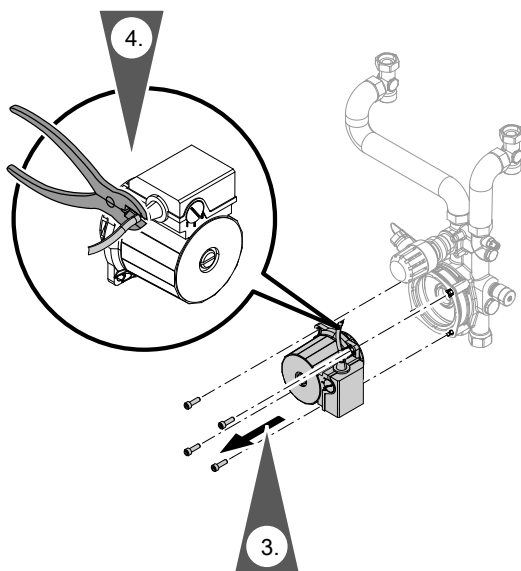
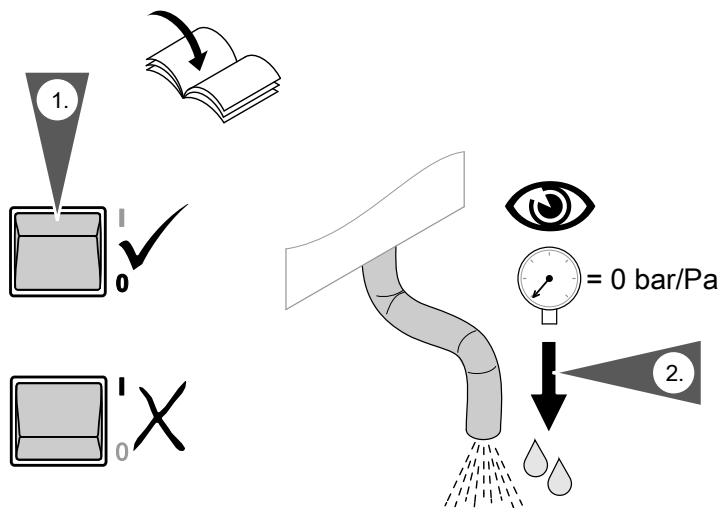

Installing the new high efficiency pump

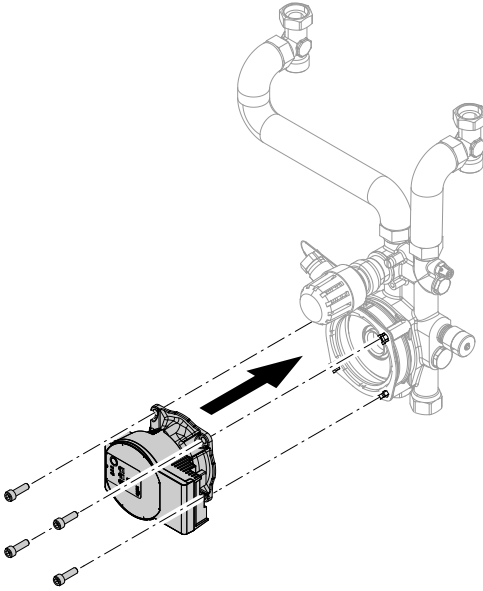

Electrical connection of the high efficiency pump plug

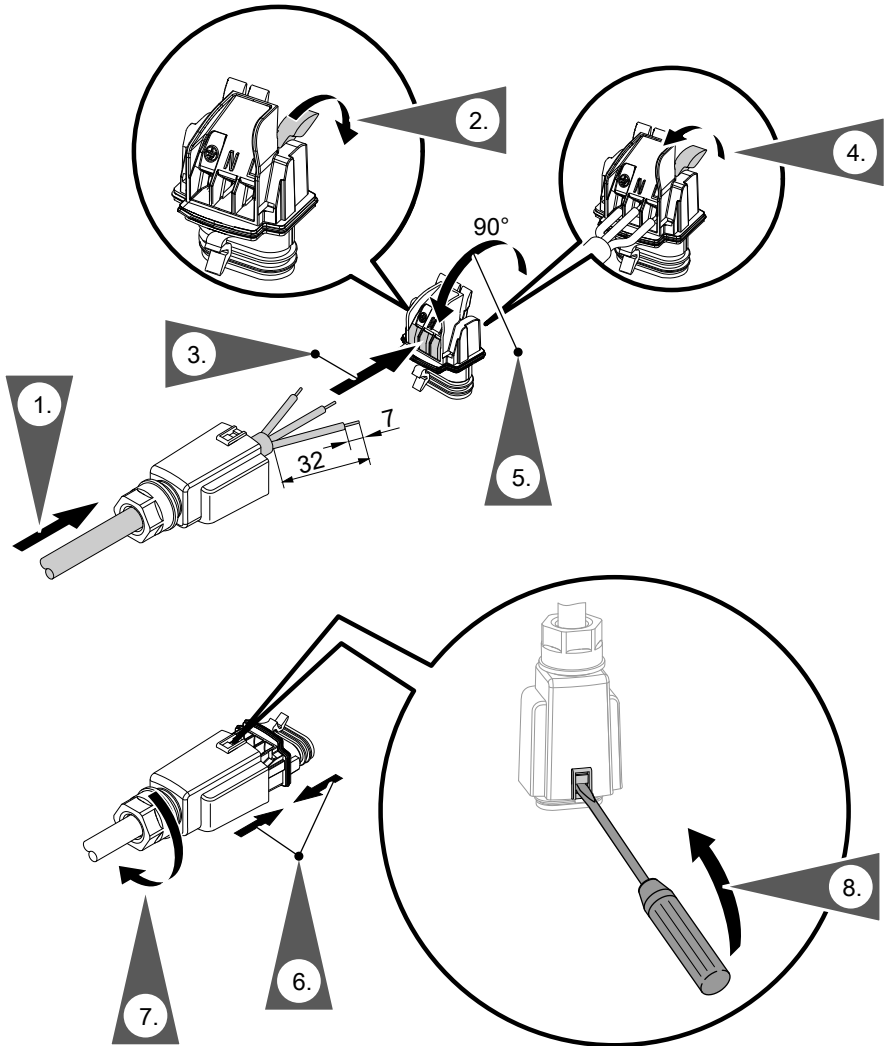

Electrical connection of the high efficiency... (cont.)

Inserting the plug and plug adaptor

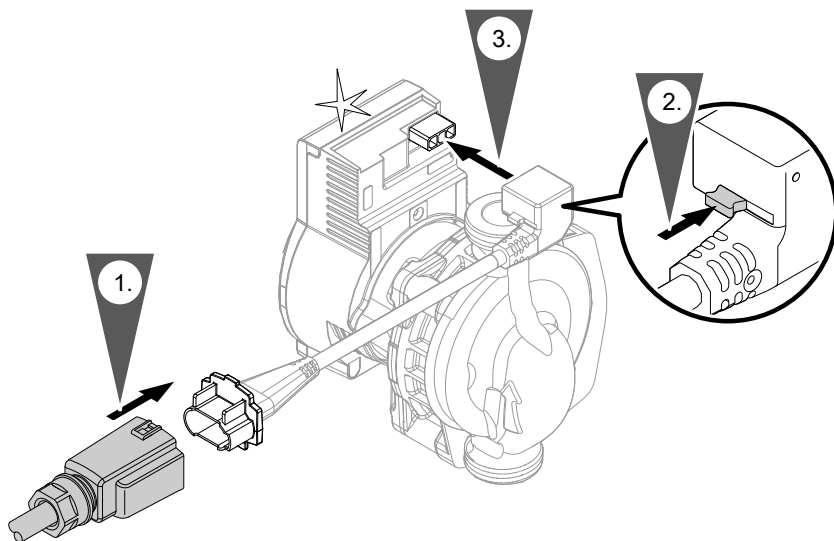

Commissioning

Filling the system

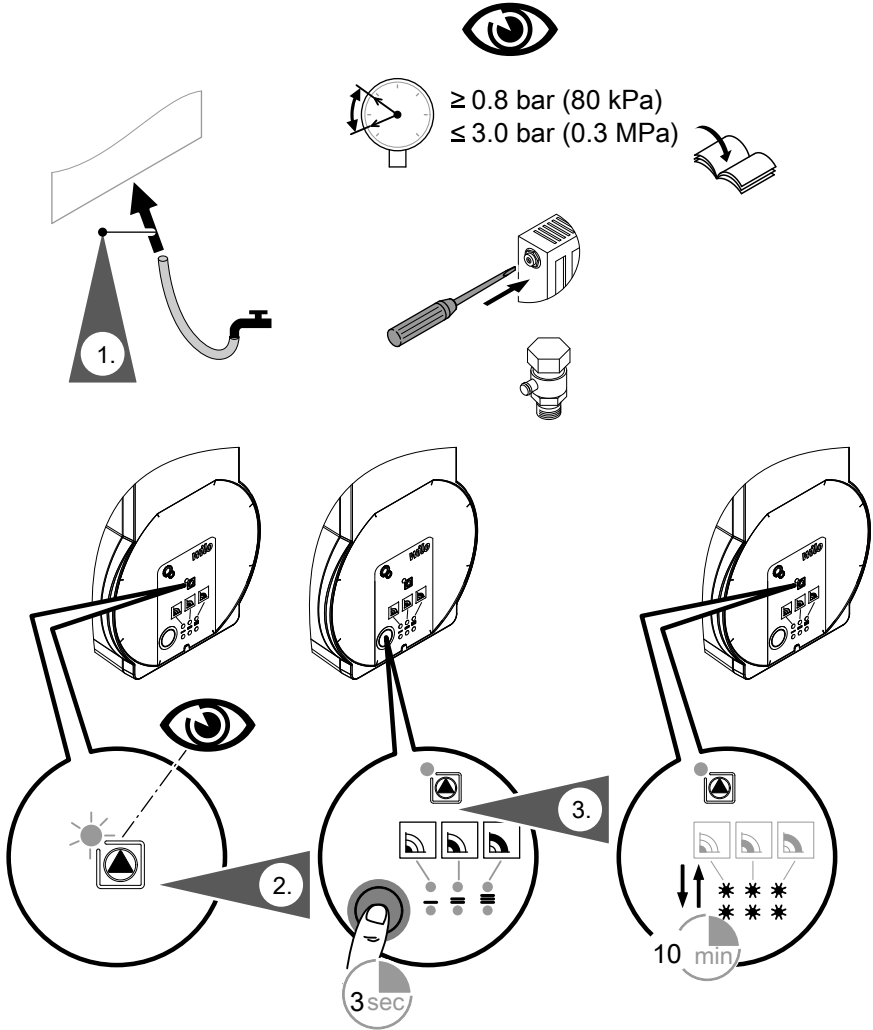

Commissioning (cont.)

Set up the new pump as detailed in the table on page 10:

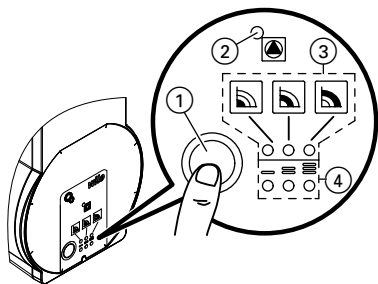

- ① Operating button for setting the pump
- ② Operating/fault indicator LED
- ③ Display of the selected speed control range
- ④ Display of the selected curve (I, II, III)

Setting the control mode

The LEDs showing the selected control modes and corresponding curves move in a clockwise direction.

- Press the operating button briefly (for approx. 1 second) to move through the various control settings.
→ The LEDs show the control mode and curve for each setting.

Constant speed (I, II, III)

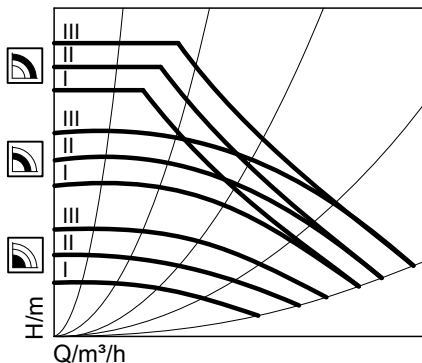









The table below shows all the possible settings (e.g. speed control range "high"; setting/curve III).

Note

After the button is pressed for the ninth time, you return to the standard setting.

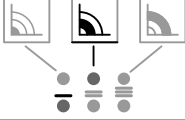
Commissioning (cont.)

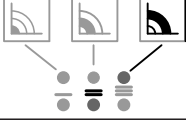
Press the operating button (for 1 second each time)	LED indicator	Control type	Setting/ Curve
Press 1 time		Speed control range: High	I
Press 2 times		Speed control range: Low	III
Press 3 times		Speed control range: Low	II
Press 4 times		Speed control range: Low	I
Press 5 times		Speed control range: Medium	III
Press 6 times		Speed control range: Medium	II
Press 7 times		Speed control range: Medium	I
Press 8 times		Speed control range: High	III
Press 9 times		Speed control range: High	II

Commissioning (cont.)

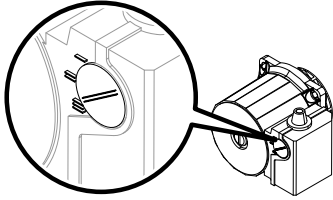

Existing setting on old pump

Recommended setting on new high efficiency pump

4 m pump: MIN (I) setting		Speed control range: Low	I
4 m pump: Medium (II) setting		Speed control range: Low	II
4 m pump: MAX (III) or variable (KM-BUS) setting		Speed control range: Low	III
5 m pump: MIN (I) setting		Speed control range: Medium	I
5 m pump: Medium (II) setting		Speed control range: Medium	II
5 m pump: MAX (III) or variable (KM-BUS) setting		Speed control range: Medium	III
6 m pump: MIN (I) setting		Speed control range: Medium	III

Commissioning (cont.)

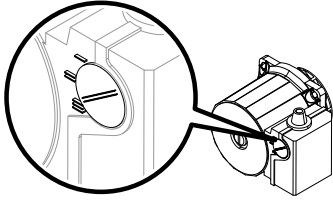

Existing setting on old pump

Recommended setting on new high efficiency pump

6 m pump: Medium (II) setting		Speed control range: High	I
6 m pump: MAX (III) or variable (KM-BUS) setting		Speed control range: High	II
7 m pump: MIN (I) setting		Speed control range: High	I
7 m pump: Medium (II) setting		Speed control range: High	II
7 m pump: MAX (III) or variable (KM-BUS) setting		Speed control range: High	III

Commissioning (cont.)

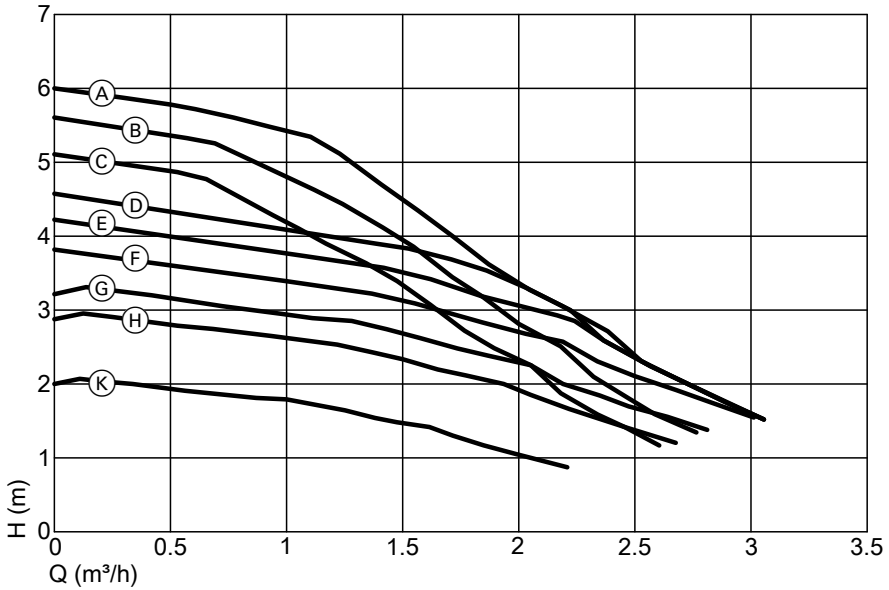

- | | |
|----------------|--------------|
| Ⓐ High (III) | Ⓕ Medium (I) |
| Ⓑ High (II) | Ⓖ Low (III) |
| Ⓒ High (I) | Ⓗ Low (II) |
| Ⓓ Medium (III) | Ⓚ Low (I) |
| Ⓔ Medium (II) | |

Only when replacing KM-BUS pumps

Note

Change the parameter/code from "internal pump speed-controlled" to "internal pump **NOT** speed-controlled"!

Otherwise the pump will run continuously and a fault message will be displayed.

Commissioning (cont.)

Constant temperature control unit with programming unit (BT2)

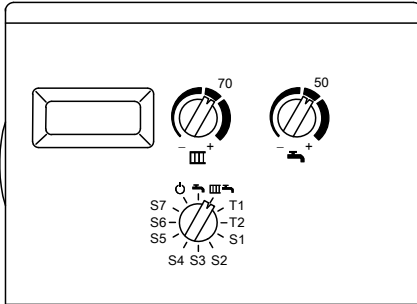

1. Select service setting "S3" on the operating program selector switch.
2. Turn rotary selector "III" fully anti-clockwise. "Eb. 1" flashes on the display.
3. Turn rotary selector "III" fully clockwise. "Eb. 2" flashes and then jumps to the value of the service setting.
4. Use rotary selector "↔" to set the value to "0" if a different value is set.
5. Set the operating program selector switch to a different position. The value is now saved.

Weather-compensated control unit with standard programming unit (BES)

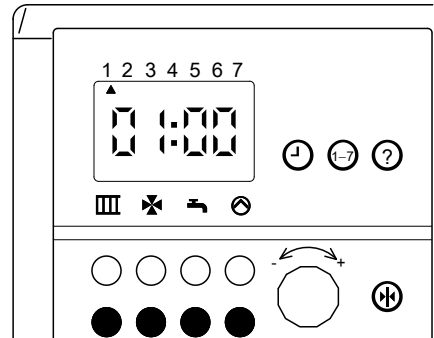

1. Press red button "↔" and blue button "X" at the same time. Keep the buttons pressed for about 5 seconds until "01:00" appears
2. Press button "⌚" and turn rotary switch "-↔+" clockwise until coding address "12:.." appears.
3. Press button "1-7". Turn rotary selector "-↔+" and set value "12:00" if a different value is set.
4. Press button "III" to exit the coding level.

Commissioning (cont.)

Weather-compensated control unit with Comfortrol programming unit (BEM)

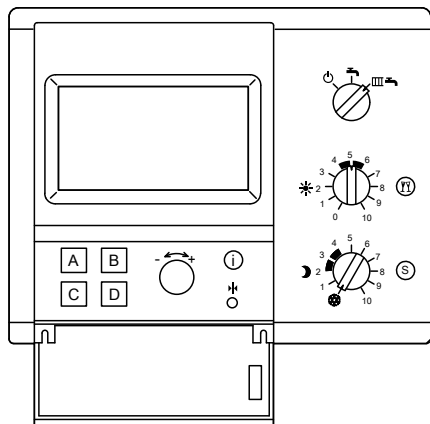

1. Open the flap:
System: Press **"D"**.
Contractor setting: Press **"C"**.
Enter code: Press **"B-C-C-B"**.
Coding level 2: Press **"C"**.
2. Press **"A"** (next) or **"B"** (back) to select coding address "013: ...".
3. Use selector "**-↔+**" to set coding address "013:000" if a different value is set.
4. Press **"D"** to confirm the change.
The change is saved.

Constant temperature control unit

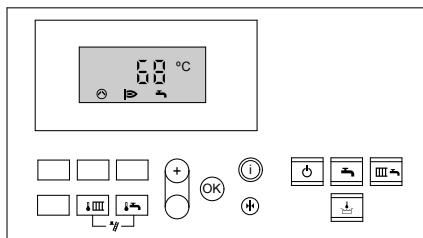

Calling up coding level 2







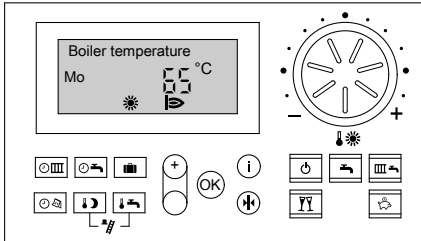



1. Press and simultaneously for approx. 2 s; confirm with .
2. Use or to select coding address "30: . "; the address flashes. Confirm with ; the value flashes.
3. Use or to set "30:0" if a different value is set; confirm with . The display briefly shows "Accepted", then the address flashes again.
4. Press and simultaneously for approx. 1 s.
Coding level is exited.

Commissioning (cont.)

Weather-compensated control unit

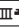

Calling up coding level 2

1. Press  and  simultaneously for approx. 2 s; confirm with .
2. Use  or  to select coding address "30: ."; the address flashes. Confirm with ; the value flashes.
3. Use  or  to set "30:0" if a different value is set; confirm with . The display briefly shows "Accepted", then the address flashes again.
4. Press  and  simultaneously for approx. 1 s. Coding level is exited.



Viessmann Climate Solutions SE
35108 Allendorf / Germany
Telephone: +49 6452 70-0
Fax: +49 6452 70-2780
www.viessmann.com



Viessmann Limited
Hortonwood 30, Telford
Shropshire, TF1 7YP, GB
Telephone: +44 1952 675000
Fax: +44 1952 675040
E-mail: info-uk@viessmann.com

6179297 Subject to technical modifications.