

Installation Instructions

for use by heating contractor



Flow Switch

Part No. 7839747 **B2HA 19-35 / B2HB 19-35, 68-125 / B2TB 19, 35, 68, 125**

Part No. 7826542 **WB2B 45, 60 / B2HA 45, 60 / B2HB 45, 57, 160, 199**

Part No. 7828795 **WB2B 80-105 / B2HA 80-100, 285-352**

for use with: Vitodens 200-W, WB2B, B2HA, B2HB

Vitodens 222-F, B2TB

Safety and Installation Requirements

Please ensure that these instructions are read and understood before starting any service work. Failure to comply with these instructions may cause product/property damage, severe personal injury and/or loss of life.

Working on the equipment

The installation, adjustment, service and maintenance of this product must be performed by a licensed professional heating contractor who is qualified and experienced in the installation, service, and maintenance of hot water boilers.

There are no user serviceable parts on the boiler, burner or control.

Ensure that main power to the equipment being serviced is off.

Ensure that the main fuel supply valve to the boiler is closed.

Take precautions to avoid accidental activation of power or fuel during service work.

Do not perform service work on any component part without ensuring safe operation of the heating system. When replacing parts, use original Viessmann or Viessmann approved replacement parts.



For more details refer to the Installation and Service Instructions applicable to the boiler.

Accessing the Flow Switch

1. Remove the external accessories connection box cover.
2. Loosen the screws at the bottom of the boiler as shown (do not remove completely).
3. Slide out and remove front enclosure panel.
4. Pivot control unit forward and down.

Vitodens 200-W

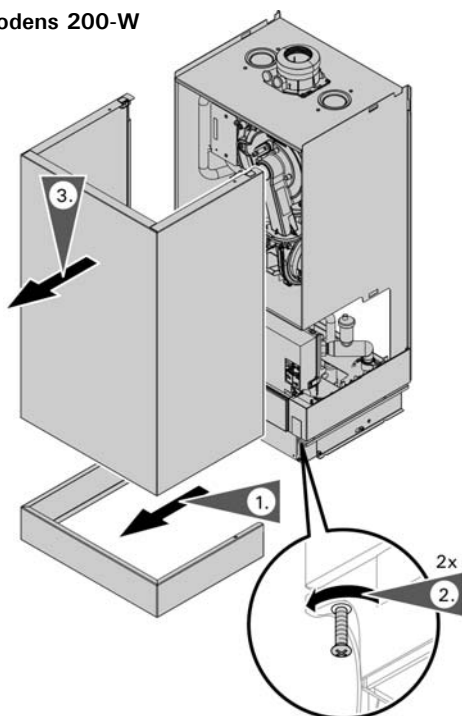

1. Remove the front upper panel.
2. Tilt and remove the lower front panel.
3. Remove the retaining screw and set aside.
4. Remove the lower front panel.
5. Pivot the control unit forward and down.

Vitodens 222-F

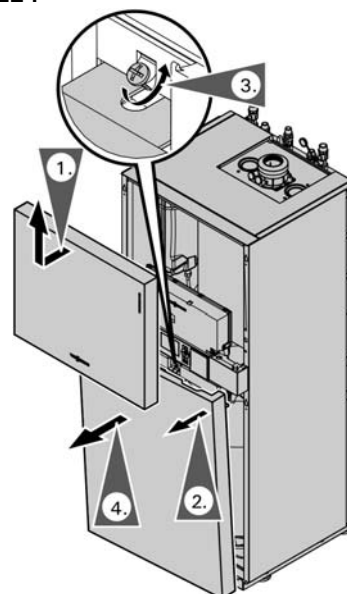

Replacing the Flow Switch

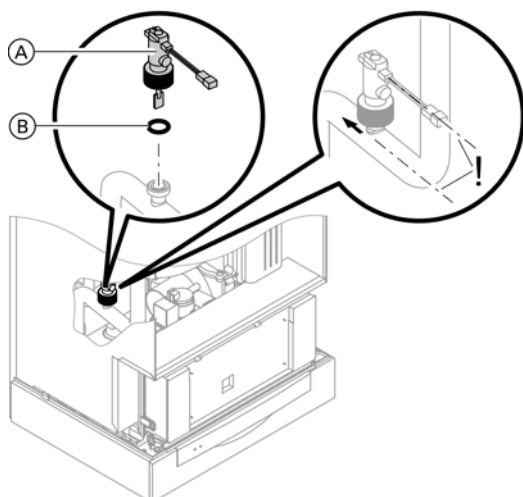

Vitodens 200-W, WB2B/B2HA 19-60
Vitodens 200-W, B2HB 19-57, 68-199

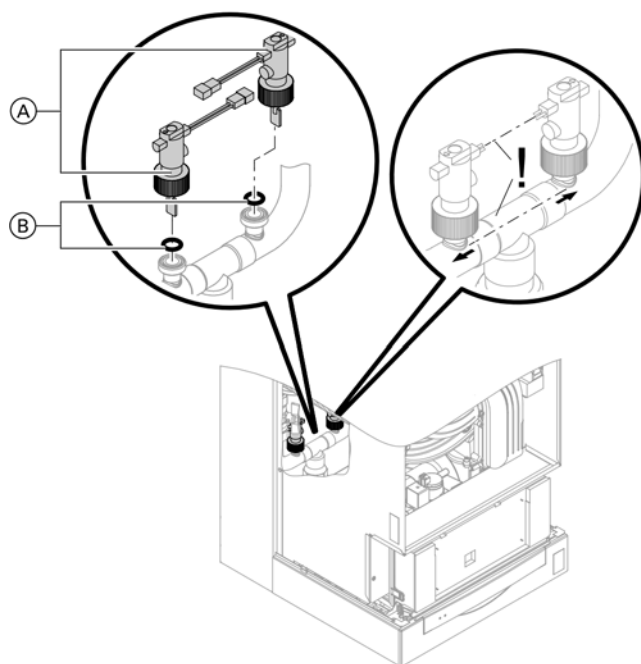

Vitodens 200-W, WB2B 80-100
Vitodens 200-W, B2HA 80-100, 285-352

Legend

- (A) Flow switch
(B) O-ring

1. Disconnect the electrical connection(s) from the flow switch(s) (A).
2. Loosen nut, then carefully tilt the flow switch (A) slightly forward and remove.
3. Unscrew the protective cap from the new flow switch (A). Remove O-ring and discard cap.
Note: Do not use oil or grease for the installation of the O-ring(s).
4. Install new O-ring(s) (B).
5. Install new flow switch(s) (A) as shown (the electrical connection should be facing against the direction of the flow and the arrow on top pointing in the direction of the flow).
6. Tighten the flow switch nut to a maximum of 71 lb.in (8 Nm).
7. Fill boiler with water, flush and check for leaks.



Refer to the Service Instructions applicable to this boiler.

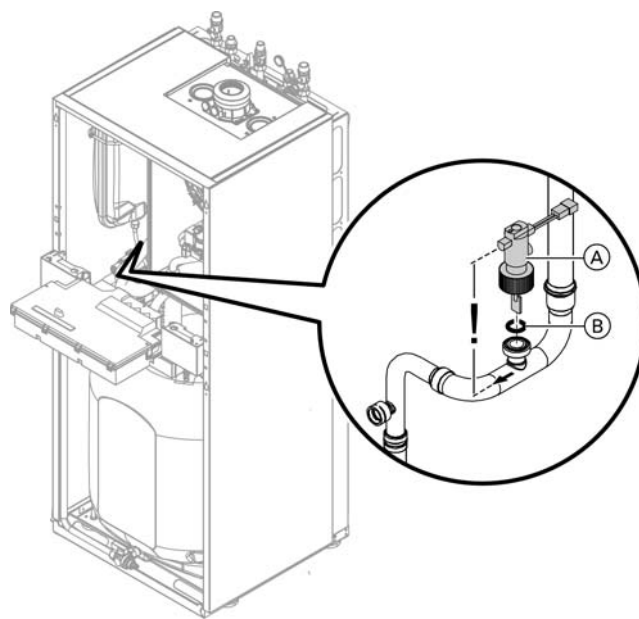

Vitodens 222-F, B2TB 19, 35, 68, 125

