

## Replacing the flow elbow

for Vitodens 100-W and Vitodens 111-W

---

### Safety instructions



**Please follow these safety instructions closely to prevent accidents and material losses.**

### Safety instructions explained



**Danger**

This symbol warns against the risk of injury.

**Note**

*Details identified by the word "Note" contain additional information.*

Installation, initial start-up, inspection, maintenance and repairs must only be carried out by a competent person (heating engineer/installation contractor).

Before working on the equipment/heating system, isolate the power supply (e.g. by removing a separate mains fuse or by means of a mains isolator) and safeguard against unauthorised reconnection.

When using gas as fuel, also close the main gas shut-off valve and safeguard against unauthorised reopening.

Repairing components which fulfil a safety function can compromise the safe operation of your heating system. For replacements, use only original spare parts supplied or approved by Viessmann.

## Opening the Vitodens and removing the burner



Installation and service instructions

## Replacing the flow elbow

### Note

Residual water may escape during removal.

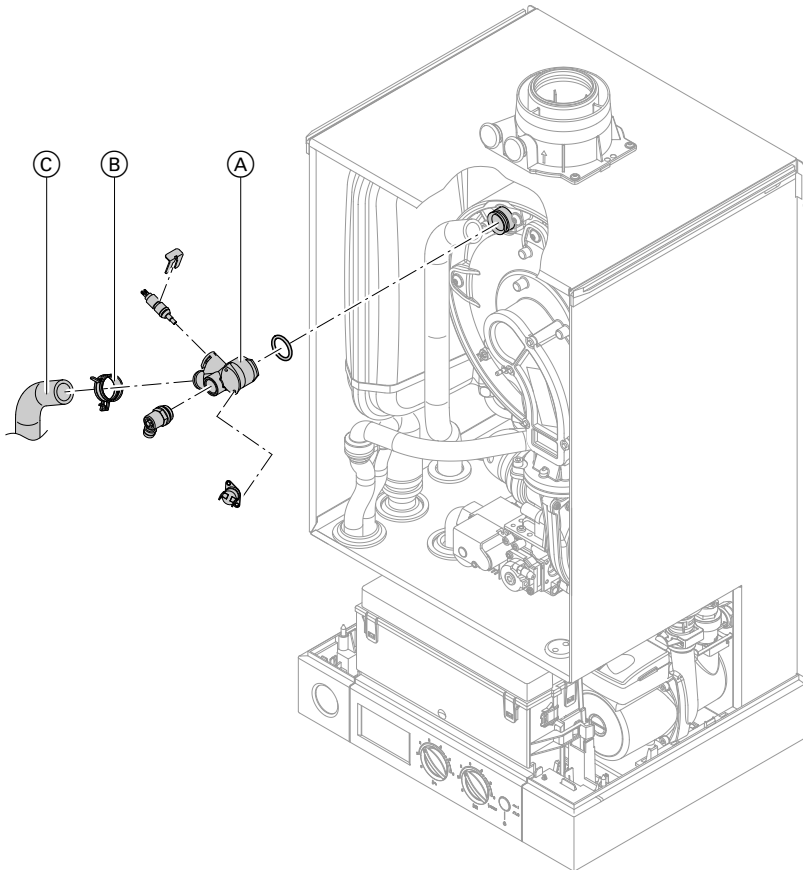

Illustration of Vitodens 100-W

1. Drain the boiler on the heating water side.



Installation and service instructions

2. Disconnect the cables from flow elbow (A).

3. Undo hose clip (B) and disconnect flow hose (C).

## Replacing the flow elbow (cont.)

4. Undo the screw and disconnect flow elbow (A) from the heat exchanger.
5. Remove the boiler water temperature sensor, thermal circuit breaker and air vent valve from old flow elbow (A) and fit to the new flow elbow.
6. Fit new flow elbow (A) with a new gasket to the heat exchanger and secure with the screw.
7. Push flow hose (C) onto flow elbow (A) and secure with hose clip (B).
8. Fit the cables to the respective components on flow elbow (A).
9. Reassemble the boiler in reverse order.
10. Fill the boiler with water, flush (vent) and check for leaks.



Installation and service instructions



### **Danger**

Escaping gas leads to a risk of explosion.

Check all gas equipment for tightness.



Viessmann Werke GmbH & Co. KG  
D-35107 Allendorf  
Telephone: +49 6452 70-0  
Fax: +49 6452 70-2780  
[www.viessmann.com](http://www.viessmann.com)

Viessmann Limited  
Hortonwood 30, Telford  
Shropshire, TF1 7YP, GB  
Telephone: +44 1952 675000  
Fax: +44 1952 675040  
E-mail: [info-uk@viessmann.com](mailto:info-uk@viessmann.com)

5355 046 GB Subject to technical modifications.