

Vitoplanar wireless receiver

For Vitoplanar wireless thermostat

Safety instructions

Please follow these safety instructions closely to prevent hazards, injury and material losses.

Safety instructions explained

- .. **Danger**
This symbol warns against the risk of injury.
- ! **Caution**
This symbol warns against the risk of material losses and environmental pollution.

Note

Details identified by the word "Note" contain additional information.

Installation, commissioning, inspection, maintenance and repairs must only be carried out by an authorised, competent person (heating engineer/installation contractor).

Before working on the appliance/heating system, isolate it from the power supply (e.g. by removing a separate fuse or by means of a mains isolator) and safeguard against unauthorised reconnection.

Repairing components that fulfil a safety function can compromise the safe operation of the system. For replacements, use only original spare parts supplied or approved by Viessmann.

Function

In conjunction with a Vitoplanar wireless thermostat, the Vitoplanar wireless receiver enables simple switching of heating appliances.

The radio frequency of 868 MHz guarantees a large range and optimum connection.

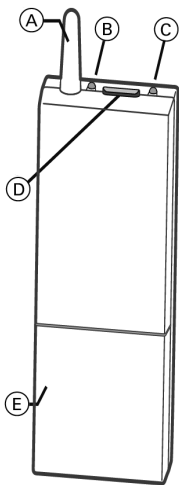

- (A) Antenna
- (B) Control lamp 1
- (C) Control lamp 2
- (D) Button
- (E) Cover, removable

Before installation

Installation location

- In the vicinity of the appliance to be switched (heat generator)
- A power supply must be available.
- Wireless reception must be available. Note the range. See "Specification".

Installation

Opening the device

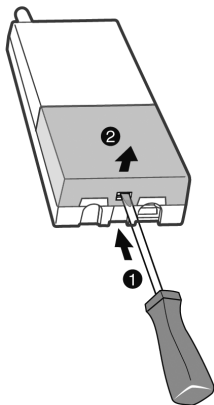

Mounting the device

Wall mounting

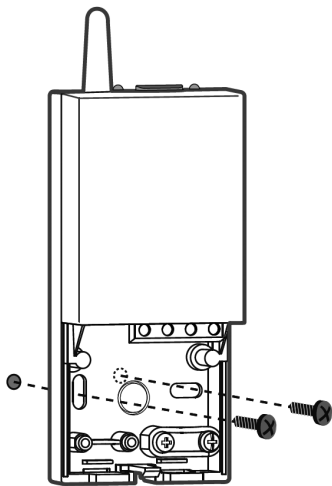

To feed the cable through the back panel, break out the pre-punched hole and guide the cable through it.

When drilling, watch out for hidden cables.

Mounting at the back of the appliance to be switched

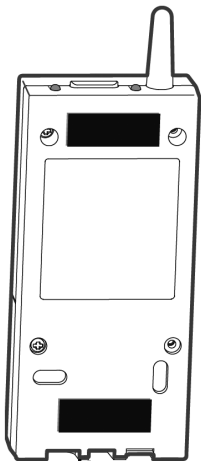

Use the adhesive pads to affix the receiver to a flat surface. Clean the surfaces beforehand.

Note

Ensure that the button on the device is still accessible.

Electrical connection

.. Danger

Incorrect wiring can lead to serious injury from electrical current and result in appliance damage.

Connections to sockets must only be made by a qualified contractor.

Note

Ensure that the cores of the power cable are connected correctly!

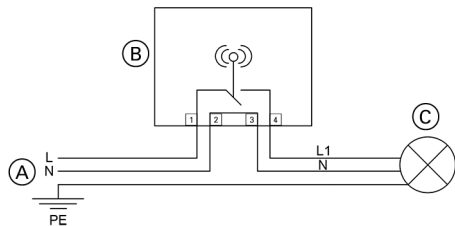

- (A) Power supply
- (B) Wireless receiver
- (C) Heating appliance

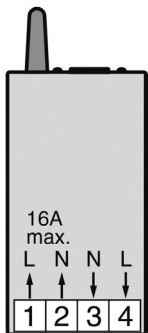

- ! Power supply phase
- ? Power supply neutral conductor
- § Heating appliance neutral conductor
- \$ Heating appliance switched phase

Tighten the strain relief.

Closing the device

- .. **Danger**
Electrical current can lead to fatal injury.
Close the cover of the device before turning on the power.

Connecting to the wireless thermostat

Press the button on the wireless receiver for longer than 3 seconds until control lamp 1 starts flashing. Now connect the transmitter (wireless thermostat).



Wireless thermostat operating instructions

Once control lamp 1 on the receiver stops flashing, the devices are assigned.

Deleting all device assignments

To delete all device assignments, press the button on the wireless receiver for longer than 30 seconds until control lamp 1 flashes briefly.

Activating wireless protocol X3D

The wireless receiver is factory-set to wireless protocol X3D.

If the wireless receiver has been switched to wireless protocol X2D, then X3D can be activated as follows:

1. Switch on the power.

Control lamp 2 indicates the active protocol:

Flashing x2: X2D

Flashing x3: X3D (no changeover required)

2. Briefly press the button on the wireless receiver. The wireless protocol is changed. Control lamp 2 flashes 3 times (X3D).
3. Press the button on the wireless receiver for longer than 3 seconds until control lamp 1 starts flashing. The transmitter (wireless thermostat) can now be connected.

Disposal of packaging

Your contractor will dispose of the packaging from your Viessmann product.

DE: Packaging waste is sent to a certified disposal contractor for recycling in line with statutory regulations.

AT: Packaging waste is sent to a certified disposal contractor for recycling in line with statutory regulations. Use the ARA statutory disposal system (Altstoff Recycling Austria AG, licence number 5766).

Specification

| | | |
|--|-----|-----------------------------|
| Power supply | V | 230 (50 Hz +/-10 %) |
| Power consumption | VA | 0.5 |
| Breaking capacity | A | Max. 16 |
| Number of receivers | | Max. 15 |
| Function type | | Type 1.C (micro switch-off) |
| Radio frequency (standard EN 300 220) | MHz | 868 |
| Wireless range | | |
| ■ In a free field | m | Approx. 100 to 300 |
| ■ In the building (depending on structural conditions and electromagnetic interference fields) | m | Approx. 20 to 30 |
| Protection class | | II |
| IP rating | | IP 44–IK 04 |
| Permissible ambient temperature | | |
| ■ Operation | °C | -5 to +50 |
| ■ Storage and transport | °C | -10 to +70 |
| Dimensions | mm | 140 x 54 x 25 |

Declaration of Conformity

Using the serial number, the Declaration of Conformity can be found on the following website:

DE: www.viessmann.de/eu-conformity

AT: www.viessmann.at/eu-conformity

CH: www.viessmann.ch/eu-conformity-de

or

www.viessmann.ch/eu-conformity-fr

Viessmann Ges.m.b.H.
A-4641 Steinhaus bei Wels
Telephone: +43 (0)7242 62381-110
Fax: +43 (0)7242 62381-440
www.viessmann.at

Viessmann Werke GmbH & Co. KG
D-35107 Allendorf
Telephone: +49 (0)6452 70-0
Fax: +49 (0)6452 70-2780
www.viessmann.de