

RC combination for Y scheme

for the Vitodens 100-W, type WB1B

Safety instructions



Please follow these safety instructions closely to prevent accidents and material losses.

Safety instructions explained



Please note

This symbol warns against the risk of material losses and environmental pollution.

Installation, initial start-up, inspection, maintenance and repairs must only be carried out by a competent person (heating engineer/installation contractor).

Before working on the equipment/heating system, isolate the power supply (e.g. by removing a separate mains fuse or by means of a mains isolator) and safeguard against unauthorised reconnection.

When using gas as fuel, also close the main gas shut-off valve and safeguard against unauthorised reopening.

Repairing components which fulfil a safety function can compromise the safe operation of your heating system. For replacements, use only original spare parts supplied or approved by Viessmann.

Installation

Opening the control unit casing



Please note

Electronic modules can be damaged by electrostatic discharges.

Before beginning work, touch earthed objects, such as heating or water pipes, to discharge static loads.

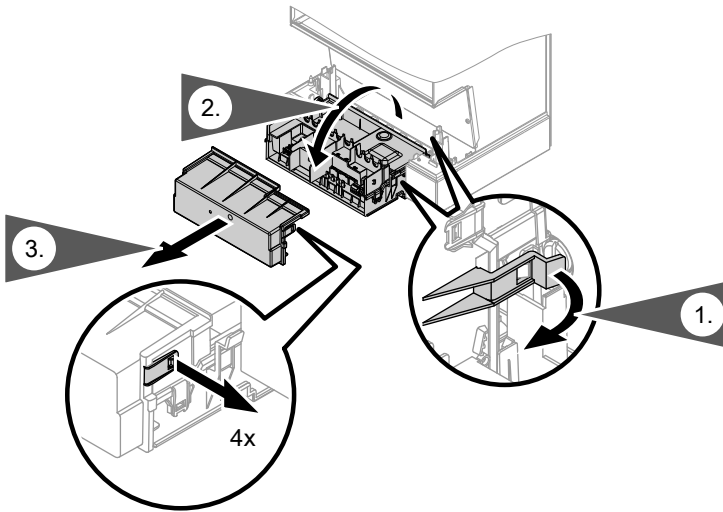

Connecting the RC combination

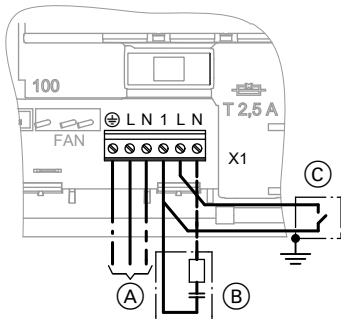

- (A) Power supply
- (B) RC combination

- (C) Heat demand

Installation (cont.)

1. Connect the RC combination and place inside the control unit wiring chamber.
2. Close the control unit casing.

Viessmann Werke GmbH&Co KG
D-35107 Allendorf
Telephone: +49 6452 70-0
Fax: +49 6452 70-2780
www.viessmann.com

Viessmann Limited
Hortonwood 30, Telford
Shropshire, TF1 7YP, GB
Telephone: +44 1952 675000
Fax: +44 1952 675040
E-mail: info-uk@viessmann.com

5712 852 GB Subject to technical modifications.



Printed on environmentally friendly,
chlorine-free bleached paper