

## Replacing the control unit

for the Vitodens 100-W

---

### Safety instructions



**Please follow these safety instructions closely to prevent accidents and material losses.**

### Safety instructions explained



#### **Please note**

This symbol warns against the risk of material losses and environmental pollution.

#### **Note**

*Details identified by the word "Note" contain additional information.*

Installation, initial start-up, inspection, maintenance and repairs must only be carried out by a competent person (heating engineer/installation contractor).

Before working on the equipment/heating system, isolate the power supply (e.g. by removing a separate mains fuse or by means of a mains isolator) and safeguard against unauthorised reconnection.

When using gas as fuel, also close the main gas shut-off valve and safeguard against unauthorised reopening.

Repairing components which fulfil a safety function can compromise the safe operation of your heating system. For replacements, use only original spare parts supplied or approved by Viessmann.

## Opening the Vitodens



Installation and service instructions

## Replacing the control unit



### Please note

Electronic assemblies can be damaged by electrostatic discharge.

Before beginning work, touch earthed objects, such as heating or water pipes, to discharge static loads.

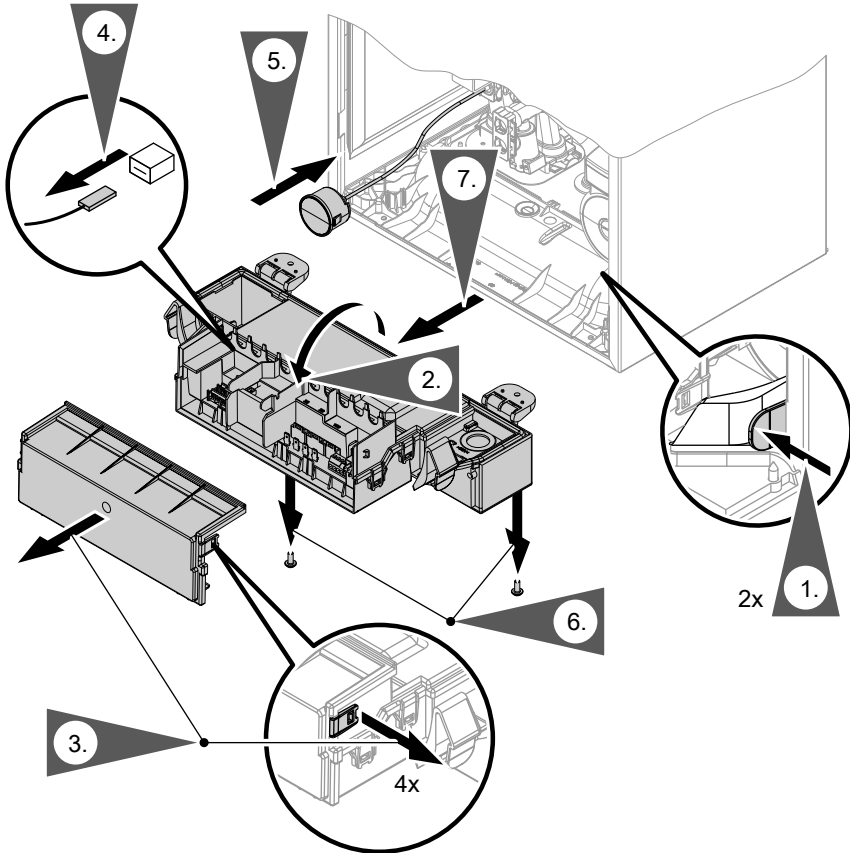

1. Push in the side locking tabs.
2. Pivot control unit forward.
3. Remove the cover.
4. Pull all plugs from the control unit.
5. Push in the side locking tabs and remove the pressure gauge from the control unit casing.
6. Undo both screws on the hinges and remove the control unit.

## Replacing the control unit (cont.)

7. Remove the control unit from the floor of the air box.
8. Secure the new control unit with two screws on the floor of the air box.
9. Fit the pressure gauge into the control unit casing.
10. Connect all plugs to the control unit.

## Matching the control unit to the boiler

Match the new control unit to the boiler by selecting a parameter set.

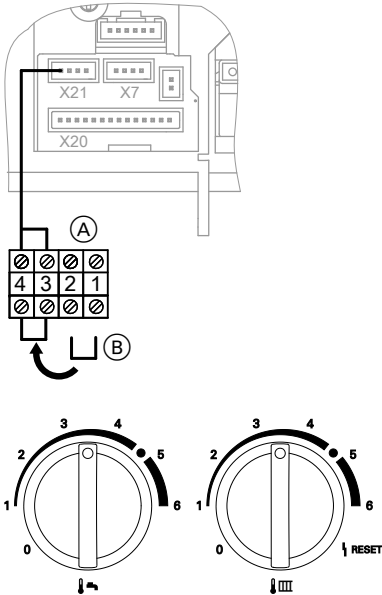

1. At terminal block (A) remove jumper (B) from terminals 1 and 2 and insert across terminals 3 and 4.
2. Switch on the ON/OFF switch.

3. Turn both rotary selectors "⚙️" and "⚙️" simultaneously into their respective central positions. "SERV" appears on the display.



## Matching the control unit to the boiler (cont.)

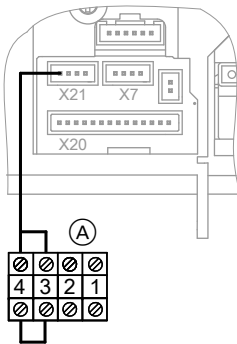
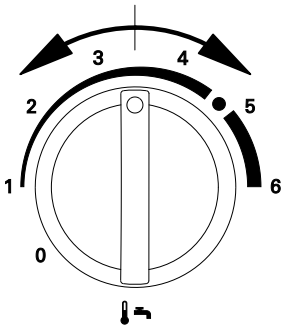
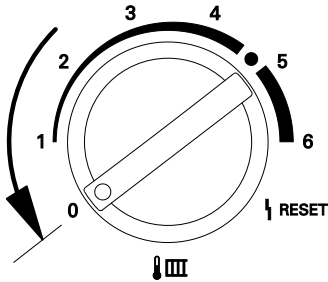

4. Turn rotary selector " " fully anti-clockwise within 2 s.  
In the display the value for the selected parameter set (1 - 12) flashes.
5. Select the parameter set that suits the boiler in accordance with the following table and the serial number (see type plate).
6. Select the correct parameter set by turning rotary selector " ".
7. The set operating mode is saved when the value stops flashing, and the control unit returns to standard mode.
8. Enable parameter setting:  
Switch the control unit ON/OFF switch first OFF and then ON again.
9. Remove new lead (A) from "X 21" again (is no longer required).

## Matching the control unit to the boiler (cont.)

10. If a lead was previously connected to "X 21" at the control unit (remote control unit or outside temperature sensor):  
Reconnect this lead to "X 21".

Serial no. (Type plate)	Parameter set No.
7441 736	4
7441 737	5
7441 739	6
7441 745	2
7441 748	1
7441 749	3

Serial no. (Type plate)	Parameter set No.
7499 418	7
7499 419	8
7499 420	14
7499 421	12
7499 422	13
7499 423	7
7499 424	8
7499 425	9
7499 426	10
7499 427	11
7499 428	12
7499 429	13

Serial no. (Type plate)	Parameter set No.
7499 430	14
7499 431	13
7499 432	7
7499 433	8
7499 434	14
7499 435	12
7499 436	13
7499 438	15
7499 440	16
7499 441	7
7499 442	8
7499 443	14
7499 444	12
7499 445	13

Serial no. (Type plate)	Parameter set No.
7501 297	1
7501 298	2
7501 823	2
7501 824	2

## Changing the gas type at the control unit

### Note

The gas type must only be converted when operating with LPG. In the delivered condition, the control unit is set to operate with natural gas.

## Changing the gas type at the control unit (cont.)

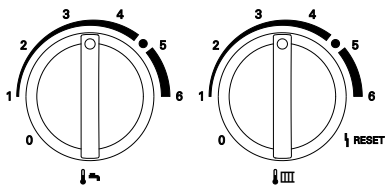

1. Switch on the ON/OFF switch.
2. Turn both rotary selectors "🔥" and "🔥" simultaneously into their respective central positions. "SERV" appears on the display.

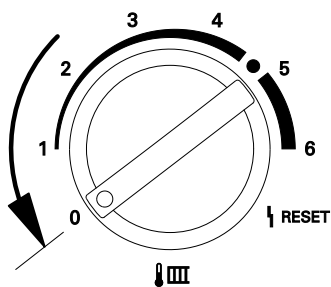

3. Turn rotary selector "🔥" fully anti-clockwise within 2 s. "🔥" and the new selected value flash on the display.

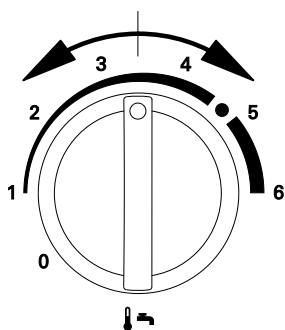

4. Change the control unit to natural gas or LPG by turning rotary selector "🔥".  
The display shows:
  - "0" for operation with natural gas  
or
  - "1" for operation with LPG.
5. The set gas type is saved when the value stops flashing, and the control unit returns to standard mode.

## Matching the burner output to the flue system



Installation and service instructions

## Closing the control unit and starting the boiler

1. Close the control unit casing and flip up the control unit.
2. Fit the front panel.
3. Start up the boiler and check for correct function.

Viessmann Werke GmbH&Co KG  
D-35107 Allendorf  
Telephone: +49 6452 70-0  
Fax: +49 6452 70-2780  
[www.viessmann.com](http://www.viessmann.com)

Viessmann Limited  
Hortonwood 30, Telford  
Shropshire, TF1 7YP, GB  
Telephone: +44 1952 675000  
Fax: +44 1952 675040  
E-mail: [info-uk@viessmann.com](mailto:info-uk@viessmann.com)

5602 997 GB Subject to technical modifications.